

North

BBG Perennial Garden

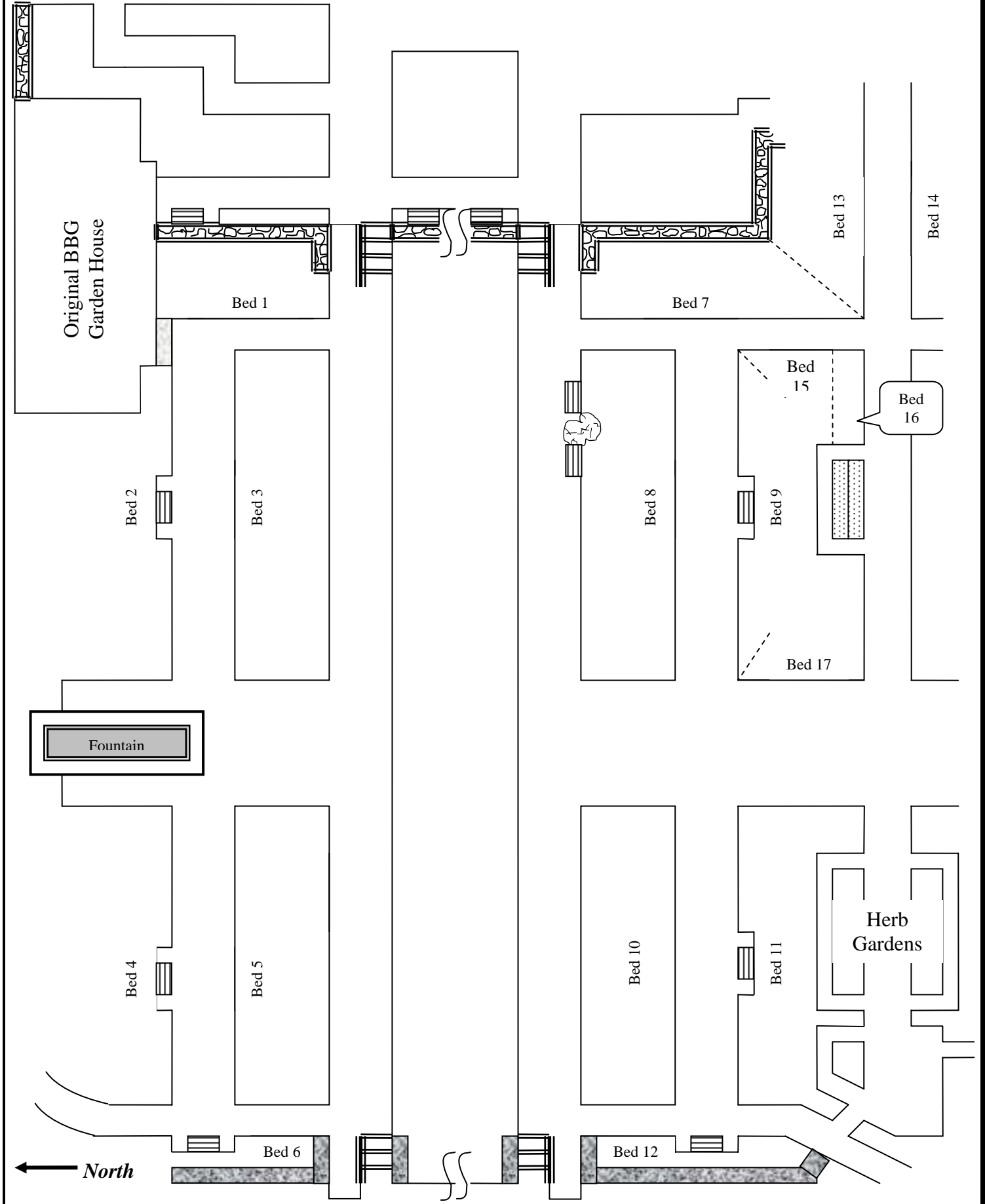

Original BBG
Garden House

Bed 1

Bed 2

Bed 3

Bed 4

Bed 5

Bed 6

Bed 7

Bed 8

Bed 10

Bed 12

Bed 13

Bed 14

Bed 15

Bed 16

Bed 9

Bed 17

Bed 11

Herb
Gardens

North

Codes used for Blooms in the Boerner Botanical Gardens

<u>Garden Codes</u>	
dg	Daylily Garden
ec	Education Center
hg	Herb Garden
hl	Heirloom Garden
ig	Iris Garden
pg	Perennial Garden
pw	Peony Walk
gh	Garden House
rg	Rock Garden
sm	Shrub Mall
arb	Arbor
gh	Garden House

Location of the Iris Garden

The "Iris Garden" consists of about 30 standard dwarf bearded irises planted just to the north of the Daylily Garden. Boerner does not consider this to be a separate garden. To find this "garden", go to the Daylily Path. Sit down on the bench just east of the restrooms. You are looking at the Iris Garden. The irises are on the east side of the daylily path.

<u>Type Code</u>	
p	perennial
b	bulb
w	woody shrub, tree, vine

<u>Bloom Codes (lower case)</u>	
e	First flower: The first flowers are completely open. You can see the stamens among the unfolded petals.
x	Full flower: At least 50% of the flowers are fully opened.
p	Past bloom: Flowers are still colorful but generally fading.
c	Cut down: Trimmed by horticulturist or rabbits/deer

Bed Code
 Although beds are not labeled, a drawing of general bed locations may be available at the reception desk. See notes below for individual gardens.

<u>GENERAL LOCATION CODES:</u>	
<u>Location Code in the bed (left)</u>	
e or w	East or west side of bed
n or s	North or south side of bed
m	Middle of bed (usually near bench or marker 50)
b	Both sides of bed (2 plants)
st	Statue between beds
<u>Location Code (right) - this code is optional</u>	
f	Front of bed
m	Middle
b	Back

<u>Location Code for Daylily Garden, Only</u>	
e	East side of path
w	West side of path
i	Island

<u>Note for Rock Garden (rg)</u>	
<u>Bed</u>	<u>Location of Bed</u>
cw-e	Center waterfall - East side
cw-w	Center waterfall - West side
e	East side of interior path
w	West side of interior path
e-st	East - Staircase
w-st	West - Staircase
i-e	Island-East
i-w	Island-West

<u>Note for Shrub Mall (sm)</u>	
<u>Bed</u>	<u>Location of Bed</u>
e	East side of mall
ne	North east bed
nw	North west bed
s	South beds
w	West side of mall
b	Both north & south part of bed
o	Outside of mall

Note for Education and Visitor Center (ec)

	<u>Bed</u>	<u>Location of Bed</u>	
N O R T H		North side and part of east side of Education & Visitors Center.	Hz 01
	04	Horseshoe island in front of Education & Visitors Center.	
	06	NW corner of Education & Visitors Center. Ferns and hostas to the front of the oak tree and wraps around building to south.	
		NW corner of Education & Visitors Center.	08
	fee	Fragrance Garden East. Around the sidewalk.	
	few	Fragrance Garden West. Around the sidewalk.	
S O U T H	02	South side and part of east side of Education & Visitors Center.	
	03	Across from shrub border. Has only Narcissus and few other perennials.	
	12	Shrub border to south of drive and SE of Education & Visitors Center.	
	05	Butterfly Garden is SW of Education & Visitors Center.	
	sbn	Silver and Blue Garden North. Around the grass.	
	sbs	Silver and Blue Garden South. Around the grass	
	sg	Sculpture Garden. Around the 6 pieces of stone sculpture just outside the entrance to the building.	

Note for Herb Garden (hg)

<u>Bed</u>	<u>Bed Theme</u>
01	Theme bed, changes every year
02	Medicinal
03	Culinary
04	Native, sun
05	Biblical
06	Herbs used in a design
07	Herbs used in a design
08	Fragrance
09	Herbs to repel insects
10	Shade herbs
11	Herbs for dye
12	Native, shade
ci	Circle
hx	Hexagon

Note for Arbor (bed = arb)

<u>Loc</u>	<u>Location description</u>
pe	Portico East
pw	Portico West

The numeral designations signifies the post

Note for Garden House

<u>Bed</u>	<u>Location of Bed</u>
e	East of front door of Garden House
w	West of front door of Garden House
ne	Area to east of door, in shaded area
nw	Area to west of door to the Plant Sales Yard crosswalk
py	Area in front of Plant Sales Yard at crosswalk

2010 Perennials in Bloom (Alpha Order of Botanical Name)

Botanical Name	Common Name	Garden	Type	Bed	Loc	Code	Mar		Apr		May		June		July		Aug		Sept		Oct						
							3	4	1	2	3	4	1	2	3	4	1	2	3	4	1	2	3	4	1	2	3
<i>Aster oblongifolius</i> 'October Skies'	Aromatic Aster	ec-s	p	sbn		la														e	x	x	x	x	x	x	p
<i>Aster oblongifolius</i> 'October Skies'	Aromatic Aster	ec-s	p	sbs		la														e	x	x	x	x	x	x	p
<i>Aster oblongifolius</i> 'Raydon's Favorite'	Aromatic Aster	ec-s	p	sbs		la														e	e	x	x	x	x	x	
<i>Aster</i> 'Wild Light Blue'	Aster	pg	p	04	eb													x	x	x	x	x	x	x	x	x	
<i>Astilbe</i> (dark pink)	Astilbe	ec-n	p	06		la							e	x	x	x											
<i>Astilbe</i> (dark pink)	Astilbe	pg	p	13	e								e	x	x	x	p										
<i>Astilbe</i> (red)	Astilbe	pg	p	06	n								e	e	x	x	x	p									
<i>Astilbe</i> (red)	Astilbe	ec-n	p	06		la							e	e	x	x	x										
<i>Astilbe</i> (salmon)	Astilbe	ec-n	p	06		la									x	x	x	p									
<i>Astilbe</i> 'Rhythm & Blues'	Astilbe	pg	p	13	w								e	e	x	x	p										
<i>Astilbe</i> 'Amethyst'	Astilbe	pg	p	07	s								e	e	e	e	x	x	x	p							
<i>Astilbe chinensis</i> 'Pumila'	Chinese Astilbe	hg	p	arb	pw4	la											x	x	x	x							
<i>Astilbe chinensis</i> 'Pumila'	Dwarf Chinese Astilbe	pg	p	12	s	nl											e	x	x	x	p	p	p				
<i>Astilbe chinensis</i> 'Purpurkerze'	Chinese Astilbe	ec-n	p	01		la								e	x	x	x	x	p								
<i>Astilbe chinensis</i> 'Purpurkerze' (syn. 'Purple Candles')	Chinese Astilbe	pg	p	11	w	la								e	e	x	x	p	p								
<i>Astilbe chinensis taquetii</i> 'Superba'	Chinese Astilbe	pg	p	08	m									e	e	x	x	x	p								
<i>Astilbe chinensis</i> var. <i>taquetii</i> 'Superba'	Chinese Astilbe	rg	p	i-e	n						e						x	x	x	x							
<i>Astilbe chinensis</i> 'Visions'	Chinese Astilbe	pg	p	11	w	la								e	x	x	x	p									
<i>Astilbe chinensis</i> 'Visions'	Chinese Astilbe	rg	p	i-w	e									e	x	x	x										
<i>Astilbe chinensis</i> 'Visions in Pink'	Chinese Astilbe	pg	p	07	n								e	e	e	e	x	x	x	p							
<i>Astilbe chinensis</i> 'Visions in Pink'	Chinese Astilbe	pg	p	14	w									e	x	x	x	p									
<i>Astilbe chinensis</i> 'Visions in Red'	Chinese Astilbe	pg	p	13	w									e	x	x	x	p									
<i>Astilbe</i> 'Country and Western'	Hybrid Astilbe	rg	p	i-e	s												x										
<i>Astilbe</i> 'Koblenz'	Japonica Hybrid	pg	p	08	e								e	e	e	x	x	p									
<i>Astilbe</i> 'Laura'	Astilbe	pg	p	07	s								e	e	e	x	x	p									
<i>Astilbe</i> 'Maggie Daley'	Astilbe	pg	p	14	e								e	e	e	x	x	p									
<i>Astilbe</i> 'Montgomery'	Hybrid Astilbe	rg	p	i-e							x					x	x										
<i>Astilbe</i> 'Rheinland'	Astilbe	ec-n	p	06		la								e	x	x	x	p									
<i>Astilbe simplicifolia</i> 'Hennie Graafland'	Star Astilbe	pg	p	14	e								e	e	e	e	x	x	p								
<i>Astilbe simplicifolia</i> 'Sprite'	Star Astilbe	pg	p	09	w												e	e	e	p							
<i>Astilbe taquetii</i> 'Superba'	Astilbe	rg	p	cw-w												x	x	x	x	x							
<i>Astilbe taquetii</i> 'Superba'	Astilbe	rg	p	i-e													x	x	x	x							
<i>Astilbe taquetii</i> 'Superba'	Astilbe	rg	p	cw-e													x	x	x	x							
<i>Astilbe x arendsii</i> 'Avalanche'	Hybrid Astilbe	pg	p	08	m								e	e	e	e	x	x	x	p							
<i>Astilbe x arendsii</i> 'Avalanche'	Hybrid Astilbe	rg	p	i-e	n								e				x	x	x								
<i>Astilbe x arendsii</i> 'Bremen'	Hybrid Astilbe	pg	p	11	w	la										e	x	x									
<i>Astilbe x arendsii</i> 'Bridal Veil' (syn. 'Brautschlier')	Hybrid Astilbe	pg	p	09	e								e	e	e	e	x	x	x	p							
<i>Astilbe x arendsii</i> 'Bunter Zauber'	Hybrid Astilbe	pg	p	16	e								e	e	e	x	x	x	p								
<i>Astilbe x arendsii</i> 'Bunter Zauber'	Hybrid Astilbe	pg	p	08	e									e	e	e	x	x	x	p							
<i>Astilbe x arendsii</i> 'Cattleya'	Hybrid Astilbe	pg	p	07	s									e	e	e	x	x									
<i>Astilbe x arendsii</i> 'Diamond' (syn. 'Diamond')	Hybrid Astilbe	pg	p	07	n								e	e	e	e	x	x	x	p							
<i>Astilbe x arendsii</i> 'Diamond' (syn. 'Diamond')	Hybrid Astilbe	pg	p	08	m								e	e	e	e	x	x	x	p							
<i>Astilbe x arendsii</i> 'Etna'	Hybrid Astilbe	pg	p	09	w								e	e	e	e	x	x	p								
<i>Astilbe x arendsii</i> 'Fanal'	Hybrid Astilbe	pg	p	08	e							e	e	e	e	x	x	x									
<i>Astilbe x arendsii</i> 'Federsee'	Hybrid Astilbe	pg	p	15	n								e	e	e	e	x	x	p								
<i>Astilbe x arendsii</i> 'Gertrude Brix'	Hybrid Astilbe	pg	p	09	e									e	x	x	p										
<i>Astilbe x arendsii</i> 'Gloria'	Hybrid Astilbe	pg	p	07	s								e	e	e	e	x	x									
<i>Astilbe x arendsii</i> 'Gloria Purpurea'	Hybrid Astilbe	pg	p	05	e									e	e	x	x	x									

