

← North

BBG Perennial Garden

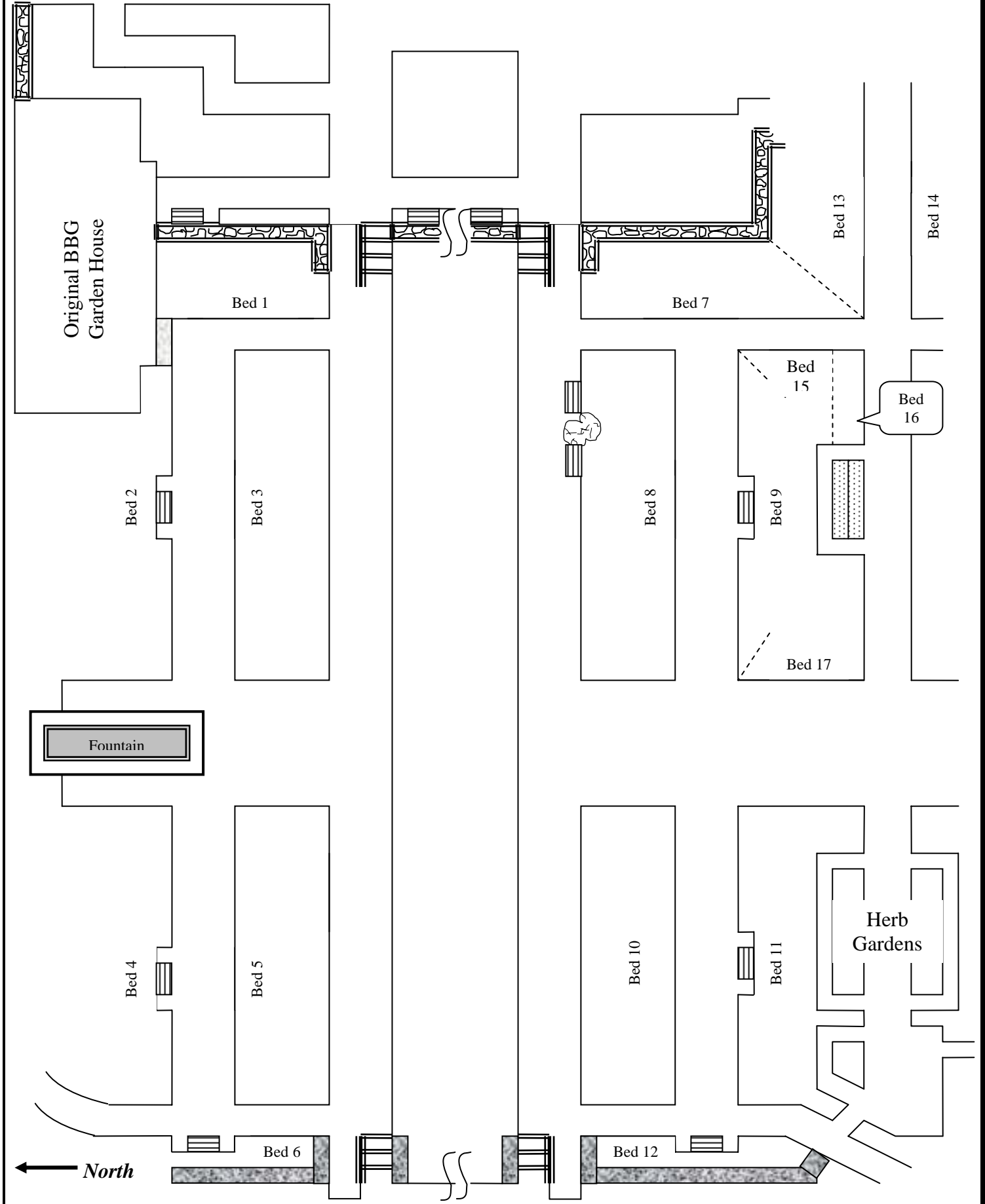

Codes used for Blooms in the Boerner Botanical Gardens

<u>Garden Codes</u>	
dg	Daylily Garden
ec	Education Center
hg	Herb Garden
hl	Heirloom Garden
ig	Iris Garden
pg	Perennial Garden
pw	Peony Walk
gh	Garden House
rg	Rock Garden
sm	Shrub Mall
arb	Arbor
gh	Garden House

Location of the Iris Garden

The "Iris Garden" consists of about 30 standard dwarf bearded irises planted just to the north of the Daylily Garden. Boerner does not consider this to be a separate garden. To find this "garden", go to the Daylily Path. Sit down on the bench just east of the restrooms. You are looking at the Iris Garden. The irises are on the east side of the daylily path.

Type Code

p	perennial
b	bulb
w	woody shrub, tree, vine

Bloom Codes (lower case)

e	First flower: The first flowers are completely open. You can see the stamens among the unfolded petals.
x	Full flower: At least 50% of the flowers are fully opened.
p	Past bloom: Flowers are still colorful but generally fading.
c	Cut down: Trimmed by horticulturist or rabbits/deer

Bed Code

Although beds are not labeled, a drawing of general bed locations may be available at the reception desk. See notes below for individual gardens.

GENERAL LOCATION CODES:

Location Code in the bed (left)

e or w	East or west side of bed
n or s	North or south side of bed
m	Middle of bed (usually near bench or marker 50)
b	Both sides of bed (2 plants)
st	Statue between beds

Location Code (right) - this code is optional

f	Front of bed
m	Middle
b	Back

Location Code for Daylily Garden, Only

e	East side of path
w	West side of path
i	Island

Note for Rock Garden (rg)

Bed Location of Bed

cw-e	Center waterfall - East side
cw-w	Center waterfall - West side
e	East side of interior path
w	West side of interior path
e-st	East - Staircase
w-st	West - Staircase
i-e	Island-East
i-w	Island-West

Note for Shrub Mall (sm)

Bed Location of Bed

e	East side of mall
ne	North east bed
nw	North west bed
s	South beds
w	West side of mall
b	Both north & south part of bed
o	Outside of mall

Note for Education and Visitor Center (ec)

	<u>Bed</u>	<u>Location of Bed</u>	
N O R T H		North side and part of east side of Education & Visitors Center.	Hz 01
	04	Horseshoe island in front of Education & Visitors Center.	
	06	NW corner of Education & Visitors Center. Ferns and hostas to the front of the oak tree and wraps around building to south.	
		NW corner of Education & Visitors Center.	08
	fee	Fragrance Garden East. Around the sidewalk.	
	few	Fragrance Garden West. Around the sidewalk.	
S O U T H	02	South side and part of east side of Education & Visitors Center.	
	03	Across from shrub border. Has only Narcissus and few other perennials.	
	12	Shrub border to south of drive and SE of Education & Visitors Center.	
	05	Butterfly Garden is SW of Education & Visitors Center.	
	sbn	Silver and Blue Garden North. Around the grass.	
	sbs	Silver and Blue Garden South. Around the grass	
	sg	Sculpture Garden. Around the 6 pieces of stone sculpture just outside the entrance to the building.	

Note for Herb Garden (hg)

<u>Bed</u>	<u>Bed Theme</u>
01	Theme bed, changes every year
02	Medicinal
03	Culinary
04	Native, sun
05	Biblical
06	Herbs used in a design
07	Herbs used in a design
08	Fragrance
09	Herbs to repel insects
10	Shade herbs
11	Herbs for dye
12	Native, shade
ci	Circle
hx	Hexagon

Note for Arbor (bed = arb)

<u>Loc</u>	<u>Location description</u>
pe	Portico East
pw	Portico West

The numeral designations signifies the post

Note for Garden House

<u>Bed</u>	<u>Location of Bed</u>
e	East of front door of Garden House
w	West of front door of Garden House
ne	Area to east of door, in shaded area
nw	Area to west of door to the Plant Sales Yard crosswalk
py	Area in front of Plant Sales Yard at crosswalk

2010 Perennials in Bloom (Alpha Order of Botanical Name)

Botanical Name	Common Name	Garden	Type	Bed	Loc	Code	Mar			Apr				May				June					July				Aug					Sept					Oct			
							3	4	1	1	2	3	4	1	2	3	4	1	2	3	4	5	1	2	3	4	1	2	3	4	1	2	3	4	5	1	2	3	4	
<i>Abelia mosanensis</i>	Fragrant Abelia	ec-n	w	06		la								e	x	x																								
<i>Acer tegmentosum</i>	Manchurian Stripe Maple	rg	w	cw-e	e					x	x																													
<i>Achillea filipendulina</i> 'Coronation Gold'	Fernleaf Yarrow	hg	p	11	e	la								x	x	x	x	x	x	x	x	x	x	x	x	x	x	x	x	x	x	x	x							
<i>Achillea millefolium</i>	Common Yarrow	hg	p	02	m	la								x	x	x	x	x	x	x	x																			
<i>Achillea millefolium</i> 'Montrose Rose'	Common Yarrow	pg	p	04	e									e	e	x	x	x	x	x	p	c																		
<i>Achillea millefolium</i> 'Oertel's Rose'	Common Yarrow	pg	p	03	wb									e	e	x	x	p																						
<i>Achillea millefolium</i> 'Red Beauty'	Common Yarrow	pg	p	03	w									e	e	e	x	x	p																					
<i>Achillea millefolium</i> 'Rose Queen'	Common Yarrow	pg	p	05	w									e	e	e	x	x	x	p	c																			
<i>Achillea ptarmica</i> 'Angel's Tears'	Sneezewort	pg	p	03	wf										e	e	e	e	x	x	x	x	x	p																
<i>Achillea sibirica</i> 'Love Parade'	Yarrow	pg	p	10	w	la												e	x	x	x	p																		
<i>Achillea</i> x 'Coronation Gold'	Hybrid Yarrow	ec-n	p	04		la								e	x	x	x	x	p	p																				
<i>Achillea</i> x 'Coronation Gold'	Hybrid Yarrow	pg	p	05	b									e	x	x	x	x	x	x	c																			
<i>Achillea</i> x 'Coronation Gold'	Hybrid Yarrow	pg	p	03	b									e	x	x	x	p																						
<i>Achillea</i> x 'Coronation Gold'	Hybrid Yarrow	pg	p	10	b	la								e	e	x	x	x																						
<i>Achillea</i> x 'Heidi'	Hybrid Yarrow	pg	p	06	m													e	x	p	p																			
<i>Achillea</i> x 'Hoffnung'	Hybrid Yarrow	pg	p	05	e													x	x	x	x	c																		
<i>Achillea</i> x 'Moonshine'	Hybrid Yarrow	pg	p	01	m									e	x	x	x	x	p																					
<i>Achillea</i> x 'Salmon Beauty' (syn. 'Lachsschonheit')	Hybrid Yarrow	pg	p	04	w													e	x	x	p																			
<i>Achillea</i> x 'Taygetea'	Hybrid Yarrow	pg	p	04	e									e	x	x	x	x	p																					
<i>Aconitum</i>		hg	p															x	x																					
<i>Aconitum carmichaelii</i>	Azure Monkshood	pg	p	04	m													e	x	x	x	x	p																	
<i>Aconitum carmichaelii</i>	Azure Monkshood	pg	p	11	w	la																											x	x	p					
<i>Aconitum carmichaelii</i>	Azure Monkshood	pg	p	05	w																		c													e				
<i>Aconitum carmichaelii</i> 'Arendsii'	Azure Monkshood	pg	p	02	wb																								e	x	p									
<i>Aconitum napellus</i> 'Album'	Monkshood	pg	p	11	e	la												e	x	x	p																			
<i>Aconitum napellus</i> 'Blue Valley'	Monkshood	pg	p	17	s										e	e	e	e	x	p																				
<i>Aconitum napellus</i> 'Rubellum'	Monkshood	pg	p	11	w	la																e																		
<i>Actaea rubra</i>	Red Baneberry	rg	p	e-st	top									x	x																									
<i>Actaea rubra</i>	Red Baneberry	pg	p	11	w	la								x	x																									
<i>Actinidia arguta</i> 'Geneva'	Bower Kiwi/Tara Vine	hg	w	03	n	la								e			x	x	p																					
<i>Adenophora confusa</i>	Ladybells	pg	p	05														x	x	x	p																			
<i>Aesculus flava</i>	Yellow Horse Chestnut	ec-n	w	04		la								e	x	x	p																							
<i>Aesculus parviflora</i>	Bottlebrush Buckeye	sm-west	w	w	n	la																e	x	p																
<i>Aesculus parviflora</i>	Bottlebrush Buckeye	ec-n	w	06		la												e	e	e	x	x	p																	
<i>Aesculus parviflora</i>	Bottlebrush Buckeye	ec-n	w	06		nl												x	x	x	p																			
<i>Aesculus parviflora</i> 'Rodger's'	Bottlebrush Buckeye	sm-east	w	e	s	la																e	x	x	x	p														
<i>Agastache foeniculum</i>	Anise Hyssop	hg	p	08	m	la												e	x	x	x	x	x	p																
<i>Agastache foeniculum</i> 'Licorice Blue'	Anise Hyssop	pg	p	04	w																	x	x	p																
<i>Agastache</i> 'Golden Jubilee'	Anise Hyssop	sm-east	p	e	n	la												e	x	x	x	x	x	p																
<i>Agastache</i> 'Golden Jubilee'	Hyssop	hg	p	08	m	la																x	x	x	x	x	x	p	x	x	p									
<i>Agastache</i> x 'Blue Fortune'	Anise Hyssop	ec-s	p	sbn		la																					x	x	x	x	x	x	x	p						
<i>Agastache</i> x 'Blue Fortune'	Anise Hyssop	pg	p	04	e																	x	x	x	p	x	p													
<i>Agrimonia eupatoria</i>	Cockleburr or Agrimony	hg	p	02		la																x	x																	
<i>Ajuga</i> 'Chocolate Chip'	Bugle Weed	pg	p	17	n									e	e	x	x	p																						
<i>Ajuga reptans</i>	Bugle Weed	pg	p	11	w	la								e	x	x	x	p																						
<i>Alchemilla erythropoda</i>	Red-stemmed Lady's Mantle	rg	p	cw-w												x					x																			
<i>Alchemilla mollis</i> 'Auslese'	Lady's Mantle	pg	p	08	m											e	e																							
<i>Alchemilla mollis</i> 'Fravermantel'	Lady's Mantle	pg	p	11	e	la												e	x	x	x	p																		

2010 Perennials in Bloom (Alpha Order of Botanical Name)

Botanical Name	Common Name	Garden	Type	Bed	Loc	Code	Mar				Apr				May					June					July				Aug				Sept					Oct																				
							3	4	1	2	3	4	1	2	3	4	1	2	3	4	1	2	3	4	5	1	2	3	4	1	2	3	4	1	2	3	4	5	1	2	3	4																
<i>Amsonia hubrichtii</i>	Arkansas Amsonia	pg	p	10	w	la									x	x	x																																									
<i>Amsonia hubrichtii</i>	Arkansas Amsonia	pg	p	08	w										e	x																																										
<i>Amsonia orientalis</i> 'Blue Ice'	Blue Star Flower	rg	p	i-w	e													x	x	x	x	x																																				
<i>Amsonia</i> 'Seaford Skies'	Blue Star Flower	pg	p	04	w												x	p	p																																							
<i>Amsonia tabernaemontana</i>	Blue Star Flower	ec-s	p	sbs		la											x	x	x	x	p																																					
<i>Amsonia tabernaemontana</i>	Blue Star Flower	pg	p	06	m												x	p																																								
<i>Amsonia tabernaemontana</i>	Blue Star Flower	pg	p	09	e												x	p																																								
<i>Amsonia tabernaemontana</i>	Blue Star Flower	pg	p	01	e	nl				e	p																																															
<i>Amsonia</i> 'WFF Selection'	Blue Star Flower	rg	p	cw-w															x	x	x	x	x																																			
<i>Amsonia orientalis</i> 'Blue Ice'	Blue Star Flower	pg	p	12	n	la													x	p	p																																					
<i>Anchusa azurea</i> 'Felton Pride Strain'	Italian Akanet	pg	p	04	w																	x	x	x																																		
<i>Andropogon gerardii</i> 'Sentinel'	Big Bluestem Grass	ec-s	p	sbn																																					e	x		x	x													
<i>Andropogon scoparius</i> 'The Blues'	Little Bluestem Grass	pg	p	03	w																																						x	x	x	x												
<i>Anemone blanda</i> (mix)	Grecian Windflower	pg	p	12	n	nl					x	x	x																																													
<i>Anemone blanda</i> (mix)	Purple Grecian Windflower	ec-s	b	sbs		nl						e	x	p																																												
<i>Anemone blanda</i> 'Blue Shades'	Grecian Windflower	sm-west	p	e	s	nl				x	x	x	p																																													
<i>Anemone blanda</i> 'Blue Shades'	Grecian Windflower	sm-west	p	s	s	nl				x	x	x	p																																													
<i>Anemone blanda</i> 'Blue Shades'	Grecian Windflower	sm-west	p	s		nl				x	x	x																																														
<i>Anemone blanda</i> 'White Splendor'	Grecian Windflower	rg	p	e-st	e						x	x	x	x																																												
<i>Anemone blanda</i> 'White Splendor'	Grecian Windflower	sm-west	p	s	s	nl					x	x	x	p																																												
<i>Anemone canadense</i>	Canadian Anemone	hg	p	04	n	la																																							e	x	p											
<i>Anemone canadensis</i>	Meadow Anemone	rg	p	w-st	s-top												x	x	x	x	x																																					
<i>Anemone nemorosa</i> var. <i>allenii</i>	Wood Anemone	rg	p	w	m							x																																														
<i>Anemone ranunculoides</i>	Yellow Wood Anemone	rg	p	w	n							x																																														
<i>Anemone ranunculoides</i> 'Flore Pleno'	Yellow Wood Anemone	rg	p	w								e	x	x	x	x																																										
<i>Anemone sylvestris</i>	Snowdrop Anemone	pg	p	06	s								x	x	x	x																																										
<i>Anemone tomentosa</i> 'Robustissima'	Grapeleaf Anemone	pg	p	02	w	nn																																							e	e	e	x	x	x	x	x	x	p				
<i>Anemone tomentosa</i> 'Robustissima'	Grapeleaf Anemone	pg	p	04	w																																								e	e	x	x	x	x	x	x	x	p				
<i>Anemone tomentosa</i> 'Robustissima'	Grapeleaf Anemone	pg	p	11	w	la																																									e	x	x	x	x	x	x	p				
<i>Anemone virginiana</i>	Thimbleweed	rg	p	cw-w								x																																														
<i>Anemone x hybrida</i> 'Margarete'	Hybrid Anemone	pg	p	15	sb																																								e	e	e	e	x	x	x	x	x					
<i>Anemone x hybrida</i> 'Max Vogel'	Hybrid Anemone	pg	p	12	s	la																																													e	x	x	x	x	x	x	p
<i>Anemone x hybrida</i> 'Party Dress'	Hybrid Anemone	pg	p	11	m	la																																																				
<i>Anemone patens</i>	Pasque Flower	hg	p	04	w	la						e	x	x	x	p																																										
<i>Angelica archangelica</i>	Angelica	hg	p	02																x	x	x	x	c																																		
<i>Anthoxanthum odoratum</i>	Sweet Vernal Grass	hg	p	08	m	la																																																				
<i>Aquilegia canadense</i>	Canadian Columbine	pg	p	14	w																	x	x	x	x	p																																
<i>Aquilegia canadensis</i>	Columbine	sm-east	p	e	m	la																																																				
<i>Aquilegia canadensis</i> 'Pink Lanterns'	Canadian Columbine	pg	p	13	mf												e	x	p																																							
<i>Aquilegia</i> sp.	Columbine	pg	p	11	e	nl																																																				
<i>Aquilegia</i> sp.	Columbine	pg	p	08	b																																																					
<i>Aquilegia</i> sp.	Columbine	pg	p	12	s	nl																																																				
<i>Aquilegia vulgaris</i> 'Leprechaun Gold'	Columbine	pg	p	08	?																																																					

2010 Perennials in Bloom (Alpha Order of Botanical Name)

Botanical Name	Common Name	Garden	Type	Bed	Loc	Code	Mar		Apr		May		June		July		Aug		Sept		Oct							
							3	4	1	2	3	4	1	2	3	4	1	2	3	4	1	2	3	4	1	2	3	4
<i>Aster oblongifolius</i> 'October Skies'	Aromatic Aster	ec-s	p	sbn		la														e	x	x	x	x	x	x	p	
<i>Aster oblongifolius</i> 'October Skies'	Aromatic Aster	ec-s	p	sbs		la															e	x	x	x	x	x	x	p
<i>Aster oblongifolius</i> 'Raydon's Favorite'	Aromatic Aster	ec-s	p	sbs		la															e	e	x	x	x	x	x	
<i>Aster</i> 'Wild Light Blue'	Aster	pg	p	04	eb																							
<i>Astilbe</i> (dark pink)	Astilbe	ec-n	p	06		la							e	x	x	x												
<i>Astilbe</i> (dark pink)	Astilbe	pg	p	13	e								e	x	x	x	p											
<i>Astilbe</i> (red)	Astilbe	pg	p	06	n								e	e	x	x	x	p										
<i>Astilbe</i> (red)	Astilbe	ec-n	p	06		la							e	e	x	x	x											
<i>Astilbe</i> (salmon)	Astilbe	ec-n	p	06		la									x	x	x	p										
<i>Astilbe</i> 'Rhythm & Blues'	Astilbe	pg	p	13	w								e	e	x	x	p											
<i>Astilbe</i> 'Amethyst'	Astilbe	pg	p	07	s								e	e	e	e	x	x	p									
<i>Astilbe chinensis</i> 'Pumila'	Chinese Astilbe	hg	p	arb	pw4	la																						
<i>Astilbe chinensis</i> 'Pumila'	Dwarf Chinese Astilbe	pg	p	12	s	nl																						
<i>Astilbe chinensis</i> 'Purpurkerze'	Chinese Astilbe	ec-n	p	01		la									e	x	x	x	p									
<i>Astilbe chinensis</i> 'Purpurkerze' (syn. 'Purple Candles')	Chinese Astilbe	pg	p	11	w	la									e	e	x	x	p	p								
<i>Astilbe chinensis taquetii</i> 'Superba'	Chinese Astilbe	pg	p	08	m										e	e	x	x	x	p								
<i>Astilbe chinensis</i> var. <i>taquetii</i> 'Superba'	Chinese Astilbe	rg	p	i-e	n							e																
<i>Astilbe chinensis</i> 'Visions'	Chinese Astilbe	pg	p	11	w	la									e	x	x	x	p									
<i>Astilbe chinensis</i> 'Visions'	Chinese Astilbe	rg	p	i-w	e										e	x	x											
<i>Astilbe chinensis</i> 'Visions in Pink'	Chinese Astilbe	pg	p	07	n								e	e	e	e	x	x	x	p								
<i>Astilbe chinensis</i> 'Visions in Pink'	Chinese Astilbe	pg	p	14	w										e	x	x	x	p									
<i>Astilbe chinensis</i> 'Visions in Red'	Chinese Astilbe	pg	p	13	w										e	x	x	x	p									
<i>Astilbe</i> 'Country and Western'	Hybrid Astilbe	rg	p	i-e	s																							
<i>Astilbe</i> 'Koblenz'	Japonica Hybrid	pg	p	08	e								e	e	e	x	x	p										
<i>Astilbe</i> 'Laura'	Astilbe	pg	p	07	s								e	e	e	x	x	p										
<i>Astilbe</i> 'Maggie Daley'	Astilbe	pg	p	14	e								e	e	e	x	x	p										
<i>Astilbe</i> 'Montgomery'	Hybrid Astilbe	rg	p	i-e								x																
<i>Astilbe</i> 'Rheinland'	Astilbe	ec-n	p	06		la									e	x	x	x	p									
<i>Astilbe simplicifolia</i> 'Hennie Graafland'	Star Astilbe	pg	p	14	e								e	e	e	e	x	x	p									
<i>Astilbe simplicifolia</i> 'Sprite'	Star Astilbe	pg	p	09	w																							
<i>Astilbe taquetii</i> 'Superba'	Astilbe	rg	p	cw-w																								
<i>Astilbe taquetii</i> 'Superba'	Astilbe	rg	p	i-e																								
<i>Astilbe taquetii</i> 'Superba'	Astilbe	rg	p	cw-e																								
<i>Astilbe x arendsii</i> 'Avalanche'	Hybrid Astilbe	pg	p	08	m								e	e	e	e	x	x	x	p								
<i>Astilbe x arendsii</i> 'Avalanche'	Hybrid Astilbe	rg	p	i-e	n								e															
<i>Astilbe x arendsii</i> 'Bremen'	Hybrid Astilbe	pg	p	11	w	la																						
<i>Astilbe x arendsii</i> 'Bridal Veil' (syn. 'Brautschlier')	Hybrid Astilbe	pg	p	09	e								e	e	e	e	x	x	x	p								
<i>Astilbe x arendsii</i> 'Bunter Zauber'	Hybrid Astilbe	pg	p	16	e								e	e	e	x	x	x	p									
<i>Astilbe x arendsii</i> 'Bunter Zauber'	Hybrid Astilbe	pg	p	08	e										e	e	e	x	x	x	p							
<i>Astilbe x arendsii</i> 'Cattleya'	Hybrid Astilbe	pg	p	07	s										e	e	e	x	x									
<i>Astilbe x arendsii</i> 'Diamond' (syn. 'Diamond')	Hybrid Astilbe	pg	p	07	n								e	e	e	e	x	x	x	p								
<i>Astilbe x arendsii</i> 'Diamond' (syn. 'Diamond')	Hybrid Astilbe	pg	p	08	m								e	e	e	e	x	x	x	p								
<i>Astilbe x arendsii</i> 'Etna'	Hybrid Astilbe	pg	p	09	w								e	e	e	e	x	x	p									
<i>Astilbe x arendsii</i> 'Fanal'	Hybrid Astilbe	pg	p	08	e								e	e	e	e	x	x	x									
<i>Astilbe x arendsii</i> 'Federsee'	Hybrid Astilbe	pg	p	15	n										e	e	e	e	x	p								
<i>Astilbe x arendsii</i> 'Gertrude Brix'	Hybrid Astilbe	pg	p	09	e																							
<i>Astilbe x arendsii</i> 'Gloria'	Hybrid Astilbe	pg	p	07	s								e	e	e	e	x	x										
<i>Astilbe x arendsii</i> 'Gloria Purpurea'	Hybrid Astilbe	pg	p	05	e										e	e	x	x										

2010 Perennials in Bloom (Alpha Order of Botanical Name)

Botanical Name	Common Name	Garden	Type	Bed	Loc	Code	Mar		Apr			May			June					July				Aug					Sept					Oct					
							3	4	1	2	3	4	1	2	3	4	1	2	3	4	1	2	3	4	1	2	3	4	1	2	3	4	1	2	3	4			
<i>Astilbe x arendsii</i> 'Gloria Purpurea'	Hybrid Astilbe	pg	p	02	e											e	e	x	p																				
<i>Astilbe x arendsii</i> 'Granet'	Hybrid Astilbe	pg	p	07	n										e	e	e	x	x	x																			
<i>Astilbe x arendsii</i> 'Montgomery'	Hybrid Astilbe	pg	p	07	n										e	e	e	e	e	x	x	x	p																
<i>Astilbe x arendsii</i> 'Red Sentinel'	Hybrid Astilbe	pg	p	09	w										e	e	x	x	x	p																			
<i>Astilbe x arendsii</i> 'Rheinland'	Hybrid Astilbe	pg	p	11	e	la												e	x	x	x	p																	
<i>Astilbe x arendsii</i> 'Sister Therese' (syn. 'Zuster Theresa')	Hybrid Astilbe	pg	p	11	w	la												e	x	x	x																		
<i>Astilbe x rosea</i> 'Peach Blossom'	Astilbe	pg	p	11	e	la												x	x	x	p																		
<i>Astilbe x rosea</i> 'Queen Alexandra'	Astilbe	pg	p	09	e										e	e	e	e	x	x	x	p																	
<i>Astilbe x thunbergii</i> 'Betsy Cuperus'	Astilbe	pg	p	08	e										e	e	e	e	x	p																			
<i>Astilbe x thunbergii</i> 'Moerheim's Glory'	Astilbe	pg	p	08	wb											e	e	e	x	x	p																		
<i>Astilbe x thunbergii</i> 'Ostrich Plume' (syn. 'Straussenfeder')	Astilbe	pg	p	07	n										e	e	e	e	x	x	x																		
<i>Astilbe x</i> 'Visions in Red'	Hybrid Astilbe	rg	p	i-e	c-h2o													x	x																				
<i>Astilboides tabularis</i>	Shield Leaf	pg	p	15	n											e	e	e	x	p																			
<i>Astilboides tabularis</i>	Shieldleaf Rodgersia	pg	p	09	wb																	e	x	p															
<i>Astragalus membranaceus</i>	Milk Vetch	hg	p	02	ni	la																						x	x										
<i>Astrantia hybrid</i> 'Rainbow'	Masterwort	pg	p	07	e													e	x	x																			
<i>Astrantia major</i> 'Sunningdale Variegated'	Masterwort	pg	p	13	e														x	x	x	x	p						c										
<i>Astrantia major</i> 'Claret'	Masterwort	pg	p	07	s										e	e	e	x	x	x	x																		
<i>Astrantia major</i> 'Lars'	Masterwort	rg	p	i-w	m														x	x	x	x	x																
<i>Astrantia major</i> 'Rosensinfonie'	Masterwort	pg	p	07	n														e	x	x	x	p																
<i>Astrantia x</i> 'Rainbow'	Hybrid Masterwort	pg	p	09	e											e	e	x	x	x	x	p																	
<i>Baptisia australis</i>	False Blue Indigo	ec-s	p	sbs		la									e	x	p																						
<i>Baptisia australis</i>	False Blue Indigo	ec-s	p	sbn		map										e	x																						
<i>Baptisia australis</i>	False Blue Indigo	pg	p	08	w										e	e	x	x	p																				
<i>Baptisia australis</i>	False Blue Indigo	pg	p	06	s													x	x	p																			
<i>Baptisia australis</i>	False Blue Indigo	pg	p	09	e													e	x	p																			
<i>Baptisia australis</i>	Wild Blue Indigo	hg	p	11	w	la												x																					
<i>Baptisia australis</i>	Wild Blue Indigo	hg	p	12	e	la												x																					
<i>Baptisia australis</i>	Wild Indigo	ec-n	p	04		la												e	x																				
<i>Baptisia leucophaea</i>	Wild Indigo	ec-n	p	04		la												e	x	x	x																		
<i>Baptisia x</i> 'Carolina Moonlight'	Yellow Wild Indigo	pg	p	08	w													e	e	x																			
<i>Berberis koreana</i>	Korean Barberry	ec-s	w	12		la												x	x																				
<i>Berberis thunbergii</i> 'Aurea'	Japanese Barberry	sm-east	w	e	m	la												e	x	p																			
<i>Berberis thunbergii</i> 'Crimson Pygmy'	Japanese Barberry	sm-east	w	e	m	la												e	x	p																			
<i>Berberis thunbergii</i> 'Rose Glow'	Japanese Barberry	sm-west	w	e	m	la												e	x	p																			
<i>Bergenia cordifolia</i>	Heartleaf Bergenia	pg	p	13	b													e	e	x	p																		
<i>Boltonia asteroides</i> 'Snowbank'	White Boltonia	pg	p	12	m	la																							e	e	x	x	x						
<i>Boltonia asteroides</i> 'Snowbank'	White Boltonia	pg	p	02	w														e	e	e																		
<i>Boltonia asteroides</i> 'Snowbank'	White Boltonia	ec-n	p	fee		la																							e	x	x	x	p						
<i>Borage officinalis</i>	Borage	hg	p																																				
<i>Brunnera macrophylla</i>	Heartleaf Brunnera	pg	p	15	n													e	x	x	x	x	p																
<i>Brunnera macrophylla</i> 'Emerald Mist'	Heartleaf Brunnera	pg	p	08	e														x	x	x																		
<i>Brunnera macrophylla</i> 'Emerald Mist'	Heartleaf Brunnera	rg	p	i-w	m															x	x	x																	
<i>Brunnera macrophylla</i> 'Jack Frost'	Heartleaf Brunnera	ec-n	p	fee		la														x	x	x																	
<i>Brunnera macrophylla</i> 'Jack Frost'	Heartleaf Brunnera	pg	p	09	w															x	x	x	p																

2010 Perennials in Bloom (Alpha Order of Botanical Name)

Botanical Name	Common Name	Garden	Type	Bed	Loc	Code	Mar		Apr			May			June				July				Aug				Sept					Oct																
							3	4	1	2	3	4	1	2	3	4	1	2	3	4	5	1	2	3	4	1	2	3	4	1	2	3	4	5	1	2	3	4										
<i>Brunnera macrophylla</i> 'Jack Frost'	Heartleaf Brunnera	rg	p	i-w	s							x	x	x	x																																	
<i>Brunnera macrophylla</i> 'Langtrees'	Heartleaf Brunnera	rg	p	i-w	mn							x	x	x	x																																	
<i>Brunnera macrophylla</i> 'Silver Wings'	Heartleaf Brunnera	rg	p	i-e	s							x	x	x																																		
<i>Buddleia davidii</i> 'Dartmoor'	Butterfly Bush	ec-s	p	05		la									x																				x	x	x	x	p									
<i>Buddleia davidii</i> 'Nanho Purple'	Butterfly Bush	ec-s	p	05		la																																										
<i>Buddleia davidii</i> 'Red Plume'	Butterfly Bush	ec-s	p	05		la																																										
<i>Buddleia davidii</i> 'White Profusion'	Butterfly Bush	ec-s	p	05		la																																										
<i>Buphthalmum speciosum</i> (syn. <i>Telekia speciosa</i>)	Scented Ox-eye	pg	p	11	e	la										e	x	x	x	x	p	p														e	e	e	e	p								
<i>Buxus microphylla</i> 'Koreana'	Korean Boxwood	hg	w	08	w	nl							e	x	x	x	p																															
<i>Cacalia muhlenbergii</i>	Indian Plantain	pg	p	04	e																	e	x																									
<i>Calamagrostis acutiflora</i> 'Karl Foerster'	Feather Reed Grass	ec-n	p	04		la														e	x	x	x	x	x	x	x	x	x	x	x	x	x	x	x	x	x	x	x	x	x	x						
<i>Calamagrostis acutiflora</i> 'Karl Foerster'	Feather Reed Grass	ec-s	p	12		la																																										
<i>Calamagrostis acutiflora</i> 'Karl Foerster'	Feather Reed Grass	pg	p	13	e																																											
<i>Calamagrostis acutiflora</i> 'Karl Foerster'	Feather Reed Grass	pg	p	12	m	la																																										
<i>Calamagrostis arundinacea</i> var. <i>brachytricha</i>	Korean Reed Grass	pg	p	14	m																																e	x	x	x	x	x	x	x				
<i>Calamagrostis brachytricha</i>	Reed Grass	ec-n	p	01		la																																				e	x	x	x	x		
<i>Calamintha nepeta</i>	Calamint	pg	p	11	e	la																																										
<i>Calamintha nepeta</i>	Calamintha	hg	p	08	w	la																																										
<i>Calamintha nepeta</i> 'Montrose White'	Calamint	sm-west	p	w	n	la																																										
<i>Calamintha nepeta</i> spp. <i>nepeta</i>	Calamint	ec-s	p	sbn		la																																										
<i>Calycanthus</i> spp	Sweetshrub	hg	w	12	hb																																											
<i>Camassia leichtlinii</i> (no tag... just south of red electric flag; long, slender light blue petals)	Quamash	pg	p	15	n	nl																																										
<i>Camassia quamash</i> 'Midnight Mystique'	Quamash	pg	p	07	n																																											
<i>Campanula alliariifolia</i>	Spurred Bellflower	pg	p	11	e	la																																										
<i>Campanula carpatica</i> 'Deep Blue Clips'	Carpathian Harebell	pg	p	07	n																																											
<i>Campanula cochlearifolia</i> 'Bavaria Blue'	Spiral Bellflower	ec-s	p	sbs		la																																										
<i>Campanula cochlearifolia</i> 'Bavaria Blue'	Spiral Bellflower	pg	p	08	w																																											
<i>Campanula glomerata</i> 'Caroline'	Clustered Bellflower	ec-s	p	sbs		la																																										
<i>Campanula glomerata</i> 'Joan Elliot'	Clustered Bellflower	pg	p	05	e																																											
<i>Campanula glomerata</i> 'Odessa'	Clustered Bellflower	pg	p	04	w																																											
<i>Campanula glomerata</i> 'Odessa'	Clustered Bellflower	pg	p	10	w	la																																										
<i>Campanula glomerata</i> 'Superba'	Clustered Bellflower	pg	p	04	w																																											
<i>Campanula glomerata</i> 'Superba'	Clustered Bellflower	pg	p	09	w																																											
<i>Campanula latifolia</i> 'Macrantha'	Great Bellflower	pg	p	11	w	la																																										
<i>Campanula persicifolia</i>	Peachleaf Bellflower	pg	p	09	wf																																											
<i>Campanula persicifolia</i>	Peachleaf Bellflower	pg	p	08	w																																											
<i>Campanula persicifolia</i> (white)	Peachleaf Bellflower	sm-west	p	w	n	la																																										
<i>Campanula persicifolia</i> 'Alba'	Peachleaf Bellflower	pg	p	09	w																																											
<i>Campanula persicifolia</i> 'Chettle Charm'	Peachleaf Bellflower	pg	p	11	w	la																																										

2010 Perennials in Bloom (Alpha Order of Botanical Name)

Botanical Name	Common Name	Garden	Type	Bed	Loc	Code	Mar				Apr				May				June				July				Aug				Sept				Oct														
							3	4	1	2	3	4	1	2	3	4	1	2	3	4	1	2	3	4	5	1	2	3	4	1	2	3	4	1	2	3	4	5	1	2	3	4							
<i>Campanula poscharskyana</i>	Serbian Bellflower	ec-n	p	04		la												e	e	x	x	x	x	p																									
<i>Campanula poscharskyana</i>	Serbian Bellflower	pg	p	15	s														e	x	x	p	p																										
<i>Campanula punctata</i> 'Kent Bells'	Spotted Bellflower	pg	p	02	w																				x	p																							
<i>Campanula sp</i>	Bellflower	hg	p	arb	pw3	nl													x	x	x	x	x	x	x	x	x	x	x	x				x	x	x	x	x	x	x	x	x	x	x	x				
<i>Campanula trachelium</i>	Throatwort	pg	p	08	w																			e	x	x	x	p																					
<i>Campanula x 'Birch Hybrid'</i>	Hybrid Bellflower	pg	p	11	e	la																																											
<i>Caragana arborescens</i>	Siberian Peashrub	hg	w	8	e							x	x	x																																			
<i>Caragana arborescens</i>	Siberian Peashrub	hg	p	8	m								x	x	p																																		
<i>Caragana pygmaea</i>	Pygmy Pea Shrub	ec-s	w	12		la									e	x	p																																
<i>Carex eburnea</i>	Bristleleaf Sedge	rg	p	cw-e									x	x	x	x																																	
<i>Carex muskingumensis</i> 'Oehme'	Palm Sedge	pg	p	11	w	la																		e	e	x	x	x																					
<i>Carex muskingumensis</i> 'Oehme'	Palm Sedge	rg	p	cw-e																								x																					
<i>Carex pensylvanica</i>	Pennsylvania Sedge	rg	p	cw-e																																													
<i>Carex sprengei</i>	Sedge	ec-n	p	06		la																			e	e																							
<i>Carpinus caroliniana</i>	American Hornbeam	sm-west	w	s	s	la																																											
<i>Carpinus caroliniana</i>	American Hornbeam	sm-west	w	s	n	la																																											
<i>Caryopteris clandonensis</i> 'Worcester Gold'	Hybrid Bluebeard	pg	p	04	w																																												
<i>Cassia</i>	American Senna	hg	p																																														
<i>Cassia hebecarpa</i>	American Senna	pg	p	02	eb																																												
<i>Cassia marilandica</i>	Wild Senna	pg	p	13	w																																												
<i>Centaurea dealbata</i> 'Delight'	Persian Cornflower	pg	p	07	n																																												
<i>Centaurea dealbata</i> 'Steenbergii'	Persian Cornflower	pg	p	03	e																																												
<i>Centaurea macrocephala</i>	Globe Corn Flower	pg	p	02	b																																												
<i>Centaurea montana</i>	Mountain Bluet	ec-s	p	sbs		la																																											
<i>Centaurea montana</i>	Mountain Bluet	pg	p	05	e																																												
<i>Centaurea montana</i>	Mountain Bluet	pg	p	03	eb																																												
<i>Centaurea montana</i>	Mountain Bluet	sm-west	p	w	n																																												
<i>Centranthus ruber</i> 'Rosenrot'	Red Valerian	pg	p	05	w																																												
<i>Cephalaria gigantea</i>	Giant Scabiosa	pg	p	04	w																																												
<i>Cerastium tomentosum</i> var. 'Silberteppich' ('Silver Carpet')	Snow-in-Summer	pg	p	10	e	la																																											
<i>Cerastium tomentosum</i> var. 'Silberteppich' ('Silver Carpet')	Snow-in-Summer	pg	p	11	e	la																																											
<i>Cercis canadensis</i>	Eastern Redbud	ec-n	w	fee		la																																											
<i>Cercis canadensis</i>	Eastern Redbud	ec-s	w	sbs		la																																											
<i>Chaenomeles superba</i> 'Cameo'	Flowering Quince Cv.	hg	w	12	w	la																																											
<i>Chaenomeles superba</i> 'Kinjishi'	Flowering Quince Cv.	hg	w	12	w	la																																											
<i>Chaenomeles superba</i> 'Pink Lady'	Flowering Quince Cv.	hg	w	12	w	la																																											
<i>Chaenomeles superba</i> 'Stanford Red'	Flowering Quince Cv.	hg	w	12	w	la																																											
<i>Chamaemelum nobile</i>	English Chamomile	hg	p	03		la																																											
<i>Chelone glabra</i>	White Turtlehead	pg	p	11	e	la																																											
<i>Chelone glabra</i> 'Black Ace'	White Turtlehead	rg	p	cw-e																																													
<i>Chelone lyonii</i>	Pink Turtlehead	hg	p	02	e	la																																											
<i>Chelone lyonii</i>	Pink Turtlehead	pg	p	09	e																																												
<i>Chelone lyonii</i> 'Hot Lips'	Pink Turtlehead	rg	p	cw-w																																													
<i>Chelone lyonii</i> 'Hot Lips' (syn. 'Select')	Pink Turtlehead	pg	p	06	n																																												
<i>Chelone lyonii</i> 'Hot Lips' (syn. 'Select')	Pink Turtlehead	pg	p	07	n																																												
<i>Chelone obliqua</i>	Rose Turtlehead	pg	p	08	e																																												
<i>Chionanthus virginicus</i>	Fringe Tree	sm-east	w	e	n	la																																											
<i>Chionanthus virginicus</i>	White Fringe Tree	ec-n	w	06		la																																											
<i>Chionodoxa forbesii</i>	Glory of the Snow	ec-s	b	12		la																																											
<i>Chrysanthemum serotinum</i>	Hungarian Daisy	pg	p	04	eb																																												

2010 Perennials in Bloom (Alpha Order of Botanical Name)

							Mar				Apr				May					June					July				Aug				Sept					Oct												
Botanical Name	Common Name	Garden	Type	Bed	Loc	Code	3	4	1	2	3	4	1	2	3	4	1	2	3	4	5	1	2	3	4	1	2	3	4	1	2	3	4	5	1	2	3	4												
<i>Coreopsis verticillata</i>	Threadleaf Coreopsis	pg	p	02	w	nl														e	e	x	x	x	p																									
<i>Coreopsis verticillata</i>	Threadleaf Coreopsis	pg	p	03	b												e	e	e	x	x	x	x	p																										
<i>Coreopsis verticillata</i> 'Alba'	Threadleaf Coreopsis	pg	p	03	w												e	e	x	p																														
<i>Coreopsis verticillata</i> 'Golden Gain'	Threadleaf Coreopsis	pg	p	04	e																e	x	x	x	x	x	x	x	x	p																				
<i>Coreopsis verticillata</i> 'Golden Showers'	Threadleaf Coreopsis	sm-east	p	e	m	la															e	x	x	x	x	x	x	x	x	p																				
<i>Coreopsis verticillata</i> 'Zagreb'	Threadleaf Coreopsis	ec-n	p	04		la															e	e	e	x	x	x	x	p																						
<i>Cornus mas</i>	Cornelian Cherry Dogwood	sm-west	w	o					x	x																																								
<i>Cornus mas</i> 'Golden Glory'	Cornelian Cherry Dogwood	pg	w	07	m				x	x																																								
<i>Cornus mas</i> 'Golden Glory'	Cornelian Cherry Dogwood	pg	w	09	b				x	x																																								
<i>Cornus racemosa</i>	Gray Dogwood	sm-east	w	ne	n	la															e	x	p																											
<i>Cornus sericea</i> 'Isanti'	Red Osier Dogwood	ec-n	w	fee		la											e	e	x	p					x																									
<i>Cornus sericea</i> 'Isanti'	Red Osier Dogwood	ec-n	w	few		la											e	x	x	p					x																									
<i>Cornus stolonifera</i> 'Cardinal'	Red Osier Dogwood	ec-n	w	04		la											e	x																																
<i>Corydalis cheilanthifolia</i>	Fernleaved Corydalis	pg	p	09	w												e																																	
<i>Corydalis lutea</i>	Yellow Corydalis	pg	p	09	e																e	p																												
<i>Corylus colurna</i>		pg	p	14	e								e	e	x	x	x	p																																
<i>Corylus maxima</i> 'Purpurea'	Purple Filbert	sm-west	w	w	m				x	x																																								
<i>Cotoneaster apiculata</i>	Cranberry Cotoneaster	sm-west	w	w	n	la											x	x	p	p																														
<i>Cotoneaster apiculatus</i>	Cranberry Cotoneaster	ec-s	w	03		map															x																													
<i>Crambe cordifolia</i>	Colewort	pg	p	02	w																				e	e	x	x	p																					
<i>Crambe cordifolia</i>	Colewort	sm-east	p	e	m	la															e	x	x	c																										
<i>Crambe maritima</i>	Sea Kale	pg	p	07	n																e	x	x	x																										
<i>Crataegus viridis</i> 'Winter King'	Hawthorne	gh	w	e													x																																	
<i>Crocus kotschyanus</i>	Fall Crocus	rg	b	cw-w																																											x			
<i>Crocus</i> 'Lady Killer', 'Ruby Giant', 'Zwanenburg Bronze'		ec-n	b	04		la			x	x																																								
<i>Cydonia oblonga</i> 'Aromatnaya'	Quince	hg	w	11	w	la															e	x	x																											
<i>Cypripedium calceolus</i>	Yellow Lady's Slipper	rg	p	i-w	s-up																x	x	x	x																										
<i>Cystopteris fragilis</i>	Brittle Bladder Fern	rg	p	w																																														
<i>Dalea purpurea</i>	Purple Prairie Clover	pg	p	05																						e	x																							
<i>Daphne x baccata</i> 'Carol Mackie'		hg	w	08	e	la															e	x	x	x	p	c																								
<i>Daphne x baccata</i> 'Carol Mackie'	Daphne	hg	w	08	e	la															e	e	e	x	x	x																								
<i>Delphinium x elatum</i> 'Blue Bird'	Pacific Giant Hybrid	pg	p	03	e																				x	p																								
<i>Delphinium</i> 'Black Knight'		ec-s	p	sbs		nl																			e	x	x	x																						
<i>Delphinium</i> 'Blue Bird'		ec-s	p	sbs		la																				x	x	x										x	x	x	x									
<i>Delphinium x elatum</i> 'Black Knight'	Pacific Giant Hybrid	pg	p	01	s																				e	e	e	x	x	p																				
<i>Delphinium x elatum</i> 'Black Knight'	Pacific Giant Hybrid	pg	p	03	b	nl																			e	x	x	p																						
<i>Delphinium x elatum</i> 'Black Knight'	Pacific Giant Hybrid	pg	p	10	wb	la																				e	x	x																						
<i>Delphinium x elatum</i> 'Blue Bird'	Pacific Giant Hybrid	pg	p	02	w	nl																				x	x	x	p														r	x	x	p				
<i>Delphinium x elatum</i> 'Blue Bird'	Pacific Giant Hybrid	pg	p	10	w	la																				x	x	x	p																					
<i>Delphinium x elatum</i> 'Blue Bird'	Pacific Giant Hybrid	pg	p	05	e																					e	x	x																						
<i>Delphinium x elatum</i> 'Blue Bird'	Pacific Giant Hybrid	pg	p	08	w																						e	x	x	x																				

2010 Perennials in Bloom (Alpha Order of Botanical Name)

Botanical Name	Common Name	Garden	Type	Bed	Loc	Code	Mar		Apr			May			June			July			Aug			Sept			Oct													
							3	4	1	2	3	4	1	2	3	4	1	2	3	4	5	1	2	3	4	1	2	3	4	1	2	3	4	1	2	3	4			
							3	4	1	2	3	4	1	2	3	4	1	2	3	4	5	1	2	3	4	1	2	3	4	1	2	3	4	1	2	3	4			
<i>Delphinium x elatum</i> 'Blue Bird'	Pacific Giant Hybrid	pg	p	04	w	nl											x	x	x																					
<i>Delphinium x elatum</i> 'Blue Lace'	Pacific Giant Hybrid	pg	p	03	w												e	e	x	p																				
<i>Delphinium x elatum</i> 'Innocence'	Millenium Series	pg	p	04	w															x	x	p																		
<i>Delphinium x elatum</i> 'Royal Aspirations'	Millenium Series	pg	p	02	w	nm										e	e	e	x	x	p																			
<i>Delphinium x elatum</i> 'Royal Aspirations'	Millenium Series	pg	p	04	e															x	x	x	x																	
<i>Delphinium x elatum</i> 'Superstars'	Millenium Series	pg	p	04	w																	x	x	p													x			
<i>Dentaria laciniata</i>	Toothwort	rg	p	e	e							x	x	p																										
<i>Deutzia gracilis</i>	Slender Deutzia	sm-east	w	e	m	la						e	e	x	x	x	p																							
<i>Deutzia gracilis</i> 'Nikko'	Deutzia	ec-n	w	01		la											e	e	e	x	x																			
<i>Dianthus amurensis</i>	Pink	pg	p	03	wf															e	x	x	x	p				r	x	x	x	p								
<i>Dianthus arenarius</i>	Sand Pink	pg	p	08	w							e	e	e	x	x																								
<i>Dianthus arenarius</i> f. <i>nanus</i> 'Little Maiden'	Sand Pink	pg	p	11	e	nl																																		
<i>Dianthus arenarius</i> f. <i>nanus</i> 'Little Maiden'	Sand Pink	pg	p	05	e										x	x	p																							
<i>Dianthus barbatus</i> 'Excelsior'	Sweet William	ec-n	p	few		la									e	x	x	x	x	x	x	p	p				c													
<i>Dianthus carthusianorum</i> 'Rupert's Pink'	Pink	pg	p	05	e										e	x	x																							
<i>Dianthus</i> 'Confetti White'	Pink	pg	p	10	w	la														x	x	p																		
<i>Dianthus deltoides</i> 'Starburst'	Maiden Pink	pg	p	03	e										e	x	x	p																						
<i>Dianthus gratianopolitanus</i> 'Bath's Pink'	Cheddar Pink	pg	p	01	s										e	e	x	x	x	p																				
<i>Dianthus gratianopolitanus</i> 'Firewitch'	Cheddar Pink	ec-s	p	sbs		la														x	x	x	p																	
<i>Dianthus gratianopolitanus</i> 'Firewitch'	Cheddar Pink	ec-s	p	05		la														x	x	x	p																	
<i>Dianthus</i> 'Greystone'	Pink	pg	p	02	ef											e	x	x	x	p																				
<i>Dianthus hybridus</i> 'Allwoodii Alpinus'	Hybrid Pink	pg	p	11	e	nl														x	x	x	x																	
<i>Dianthus knappii</i>	Pink	pg	p	05	e															e	x	x	x	p																
<i>Dianthus knappii</i> 'Yellow Beauty'	Hairy Garden Pink	pg	p	04	w	nm																																		
<i>Dianthus knappii</i> 'Yellow Beauty'	Hairy Gardn Pinks	pg	p	02	w																		x	p																
<i>Dianthus</i> 'Pixie'	Pink	pg	p	05	e											e	x	x	x	p																				
<i>Dianthus plumarius</i> fl. pl. 'Spring Beauty'	Cottage Pink	pg	p	10	w	nl														x	x	x	p																	
<i>Dianthus plumarius</i> fl. pl. 'Spring Beauty'	Cottage Pink	ec-s	p	sbn		nl														x	x	p																		
<i>Dianthus</i> 'Rosie Cheeks'	Hybrid Pink	hg	p	08	e	la														x	x	p																		
<i>Dianthus</i> 'Rosie Cheeks'	Hybrid Pink	hg	p	08	e	la																																		
<i>Dianthus</i> sp.	Carnation	hg	p	arb	pw3	nl								x	x	x	x																							
<i>Dianthus</i> 'Spring Beauty'	Pink	pg	p	06																x	x																			
<i>Dianthus</i> 'Spring Charme'	Pink	pg	p	06	n																e	x	x	x	p															
<i>Dicentra cucullaria</i>	Dutchman's Breeches	rg	p	e	s								x	x																										
<i>Dicentra eximia</i> 'Dolly Sods'	Bleeding Heart	rg	p	cw-e											x	x	x	x	x	x	x	x	x	x	x	x	x	x	x											
<i>Dicentra eximia</i> 'Zestful'	Fringed Bleeding Heart	pg	p	06	n															e	x	x	x	x	x	x	p	p												
<i>Dicentra eximia</i> 'Zestful'	Fringed Bleeding Heart	pg	p	15	s															x	x	x	x	x	x	x	x	p												
<i>Dicentra spectabilis</i>	Bleeding Heart	pg	p	07	nb																x	x	x	x	p															
<i>Dicentra spectabilis</i>	Bleeding Heart	pg	p	09	wb																e	x	x	x																
<i>Dicentra spectabilis</i>	Old Fashioned Bleeding Heart	rg	p	i-e	c-up																x	x	x	x																
<i>Dicentra spectabilis</i> 'Gold Heart'	Bleeding Heart	pg	p	09	w																e	x	x	x																
<i>Dictamnus albus</i> 'Rubus'	Gas Plant	pg	p	02	e	nl															e	x	x	x	p															
<i>Dictamnus albus</i> var. <i>purpurea</i>	Gas Plant	pg	p	02	st																e	x	x	p																
<i>Digitalis grandiflora</i>	Yellow Foxglove	hg	w	12	w	la																																		
<i>Digitalis grandiflora</i>	Yellow Foxglove	hg	p	12	w	la																																		
<i>Digitalis grandiflora</i> 'Carillon'	Foxglove	pg	p	07	n																e	e	x	p																
<i>Digitalis purpurea</i>	Common Foxglove	hg	p	11	e	la																																		

2010 Perennials in Bloom (Alpha Order of Botanical Name)

Table with columns: Botanical Name, Common Name, Garden, Type, Bed, Loc, Code, and bloom periods for months Mar through Oct. The bloom period columns are further subdivided into weeks (e.g., 1-4 for Mar, 1-5 for May, 1-5 for July, 1-5 for Sept). 'x' indicates bloom, 'e' indicates early bloom, and 'p' indicates peak bloom.

2010 Perennials in Bloom (Alpha Order of Botanical Name)

Botanical Name	Common Name	Garden	Type	Bed	Loc	Code	Mar			Apr			May				June				July			Aug				Sept				Oct																										
							3	4	1	2	3	4	1	2	3	4	1	2	3	4	5	1	2	3	4	1	2	3	4	1	2	3	4	5	1	2	3	4																				
<i>Geranium macrorrhizum</i> 'Bevan's Variety'	Bigroot Geranium	rg	p	cw-w										x	x	x	x																																									
<i>Geranium macrorrhizum</i> 'Ingwersen's Variety'	Bigroot Geranium	ec-s	p	05		map								e	x	x	x	p																									r															
<i>Geranium macrorrhizum</i> 'Ingwersen's Variety'	Bigroot Geranium	ec-s	p	02		la								e	x	x	x	p																																								
<i>Geranium macrorrhizum</i> 'Ingwersen's Variety'	Bigroot Geranium	pg	p	14	e									e	e	e	x	x	p																																							
<i>Geranium macrorrhizum</i> 'Ingwersen's Variety'	Bigroot Geranium	pg	p	11	w	la									e	e	e	e																																								
<i>Geranium maculatum</i>	Cranesbill	rg	p	i-w	s									x	x	x																																										
<i>Geranium maculatum</i>	Spotted Cranesbill	hg	p	12	e	la								x	x	x																																										
<i>Geranium maculatum</i>	Spotted Geranium	hg	p	04	w	la								x	x	x	p																																									
<i>Geranium maculatum</i>	Spotted Geranium	pg	p	02	b									e	e	x	x	x	p																																							
<i>Geranium phaeum</i> 'Sambor'	Mourning Widow	pg	p	13	e	nl								e	e	e	e	x	p																																							
<i>Geranium pratense</i> 'Dark Reiter'	Meadow Cranesbill	ec-n	p	04		la																																																				
<i>Geranium pratense</i> 'Dark Reiter'	Meadow Cranesbill	pg	p	13	w																																																					
<i>Geranium pratense</i> 'Painters Palette'	Meadow Cranesbill	pg	p	09	e																																																					
<i>Geranium pratense</i> 'Splish Splash'	Meadow Cranesbill	pg	p	05	w																																																					
<i>Geranium pratense</i> 'Victor Reiter Jr.'	Meadow Cranesbill	pg	p	08	w																																																					
<i>Geranium sanguineum</i>	Bloody Cranesbill	pg	p	09	w																																																					
<i>Geranium sanguineum</i>	Bloody Cranesbill	pg	p	02	m																																																					
<i>Geranium sanguineum</i> 'Album'	Bloody Cranesbill	pg	p	04	w																																																					
<i>Geranium sanguineum</i> 'Album'	Bloody Cranesbill	pg	p	08	w																																																					
<i>Geranium sanguineum</i> 'Cedric Morris'	Bloody Cranesbill	pg	p	03	w																																																					
<i>Geranium sanguineum</i> 'New Hampshire Purple'	Bloody Cranesbill	pg	p	11	e	la																																																				
<i>Geranium sanguineum</i> var. <i>striatum</i>	Bloody Cranesbill	pg	p	10	e	la																																																				
<i>Geranium sanguineum</i> var. <i>striatum</i>	Bloody Cranesbill	pg	p	08	w																																																					
<i>Geranium</i> 'Sirak'	Cranesbill	pg	p	11	m	la																																																				
<i>Geranium</i> 'Sweet Heidi'	Cranesbill	pg	p	11	m	la																																																				
<i>Geranium sylvaticum</i> 'Mayflower'	Wood Cranesbill	pg	p	06	s																																																					
<i>Geranium</i> x 'Brookside'	Hybrid Geranium	pg	p	04	w																																																					
<i>Geranium</i> x 'Brookside'	Hybrid Geranium	pg	p	11	w	la																																																				
<i>Geranium</i> x 'Brookside'	Hybrid Geranium	ec-s	p	sbs	e	nl																																																				
<i>Geranium</i> x <i>cantabrigiense</i> 'Biokovo'	Cambridge Hybrid Cranesbill	ec-n	p	06		la																																																				
<i>Geranium</i> x <i>cantabrigiense</i> 'Biokovo'	Cambridge Hybrid Geranium	pg	p	03	e																																																					
<i>Geranium</i> x <i>cantabrigiense</i> 'Biokovo Karmina' (syn. 'Karmina')	Cambridge Hybrid Geranium	pg	p	05	w																																																					
<i>Geranium</i> x <i>cantabrigiense</i> 'Cambridge'	Cambridge Hybrid Geranium	pg	p	05	w																																																					
<i>Geranium</i> x <i>cantabrigiense</i> 'Karmina'	Cambridge Hybrid Geranium	ec-s	p	12	uc	map																																																				
<i>Geranium</i> x 'Johnson's Blue'	Hybrid Geranium	ec-s	p	sbs																																																						
<i>Geranium</i> x 'Johnson's Blue'	Hybrid Geranium	pg	p	05	w																																																					
<i>Geranium</i> x 'Johnson's Blue'	Hybrid Geranium	pg	p	11	e	la																																																				
<i>Geranium</i> x 'Johnson's Blue'	Hybrid Geranium	ec-s	p	sbn		la																																																				
<i>Geranium</i> x <i>oxonianum</i> 'Claridge Druce'	Hybrid Geranium	pg	p	10	w	la																																																				
<i>Geranium</i> x 'Spinners'	Hybrid Cranesbill	pg	p	08	w																																																					
<i>Geranium</i> x 'Tiny Monster'	Hybrid Cranesbill	rg	p	cw-w																																																						
<i>Geum coccineum</i> 'Cooky'	Avens	pg	p	08	w																																																					
<i>Geum coccineum</i> 'Cooky'	Avens	pg	p	13	w	nl																																																				
<i>Geum</i> 'Flames of Passion'	Avens	pg	p	04	e																																																					

2010 Perennials in Bloom (Alpha Order of Botanical Name)

Botanical Name	Common Name	Garden	Type	Bed	Loc	Code	Mar		Apr			May				June					July				Aug					Sept					Oct					
							3	4	1	2	3	4	1	2	3	4	1	2	3	4	5	1	2	3	4	1	2	3	4	1	2	3	4	5	1	2	3	4		
<i>Geum rivale</i>	Water Avens or Chocolate Root	hg	p	04	w	la							x	x	x	x																								
<i>Geum triflorum</i>	Prairie Smoke	pg	p	11	w	la						e	e																											
<i>Geum urbanum</i>	Avens	hg	p	09	e	la							x	x	p																									
<i>Geum x borisii</i>	Boris Avens	pg	p	05	e						e	x	x	x	x																									
<i>Gillenia trifoliata</i>	Bowman's Root	pg	p	11	e	la										e	x							p																
<i>Goniolimon collinum</i> 'Sea Spray'	Sea Lavender Statice	pg	p	02	e																			e	x	p														
<i>Gymnaster savatieri</i>	Aster - Boltonia Relative	pg	p	02	m																													e	x	x				
<i>Hakonechloa macra</i> 'Albo-aurea'	Hakone Grass	pg	p	06	m																													x	p					
<i>Hamamelis virginiana</i>	Witch Hazel	hg	w	08	w	la					p																							e	x	x	x			
<i>Helenium autumnale</i>	Sneezeweed	hg	p	04	n	la																	e	x	x	x	x	x	x	x	p									
<i>Helenium hoopesii</i>	Sneezeweed	ec-s	p	05		la																											x							
<i>Helenium hoopsii</i>	Orange Sneezeweed	pg	p	04																				x	x															
<i>Helenium x 'Moerheim Beauty'</i>	Sneezeweed	ec-s	p	05		la																												x	x	x	x	p		
<i>Helianthus decapetalus</i> 'Flore plena'	Sunflower	pg	p	04	e									e	e	x	x	x	x	x	x	x	x	x	x	x	x	x	x	x	x	x	x	x	p					
<i>Helianthus salicifolius</i> 'Lemon Queen'	Willowleaf Sunflower	pg	p	04	e																		x	x	x	x	x	x	x	x	x	x	x	x	x					
<i>Helianthus x multiflorus</i> 'Loddon Gold'	Many-flowered Sunflower	pg	p	03	wb	nl						e																												
<i>Helictotrichon sempervirens</i>	Blue Oat Grass	pg	p	12	n	la										x	x	p																						
<i>Heliopsis helianthoides</i>	False Sunflower	ec-s	p	05											e	x	x										x	x	x	x										
<i>Heliopsis helianthoides</i> 'Bressingham Double'	Sunflower Heliopsis	pg	p	10	w	la												x	x	x	p	p																		
<i>Heliopsis helianthoides</i> 'Karat'	Sunflower Heliopsis	pg	p	10	m	la												e	x	x																				
<i>Heliopsis helianthoides</i> 'Patula'	Sunflower Heliopsis	pg	p	05	w									e	x	x	x	x	x	x	x	x	x	x	x	x	x	x	x	x	x	x	x	x	x					
<i>Heliopsis helianthoides</i> 'Prairie Sunset'	Sunflower Heliopsis	pg	p	07	nb									e	x	x	x	x	x	x	x	x	x	x	x	x	x	x	x	x	p									
<i>Heliopsis helianthoides</i> 'Summer Sun' (syn. 'Sommersonne')	Sunflower Heliopsis	pg	p	10	w	la										x	x	x	x	x	x	x	p	p	p	p	p	p	p	p	p	p	p	p						
<i>Heliopsis helianthoides</i> var. <i>scabra</i> 'Summer Nights'	Sunflower Heliopsis	ec-s	p	05		la								e	x	x										x	x	x	x	p										
<i>Heliopsis helianthoides</i> var. <i>scabra</i> 'Orange King'	Sunflower Heliopsis	pg	p	03	eb									e	x	x	x	x	x	x	x	x	x	x	x	x	x	x	x	x	p									
<i>Heliopsis helianthoides</i> var. <i>scabra</i> 'Orange King'	Sunflower Heliopsis	pg	p	09	e													e	x	x	x	x	p																	
<i>Heliopsis helianthoides</i> var. <i>scabra</i> 'Summer Nights'	Sunflower Heliopsis	pg	p	04	w											e	x	x	x	x	x	x	x	x	x	x	x	x	x	x	x	x	x	x						
<i>Helleborus foetidus</i>	Bear's Foot	hg	p	12	w	la		x	x	x	x	x	x																											
<i>Helleborus niger</i>	Christmas Rose	gh	p	ne			e	x	x	x	x																													
<i>Helleborus orientalis</i>	Hellebore	gh	p	ne				e	x	x	x																													
<i>Helleborus orientalis</i>	Lenten Rose	hg	p	12	w	la		x	x	x	x	x	x																											
<i>Helleborus orientalis</i> 'Rosy Plum'	Hellebore	gh	p	ne				e	x	x	x																													
<i>Hemerocallis</i> 'Bittersweet Destiny'	Daylily	pg	p	08	e													e	e	x	x	p																		
<i>Hemerocallis</i> 'Absolute Treasure'	Daylily	dg	p	i	05-30																		x	x	x	p														
<i>Hemerocallis</i> 'After Glow'	Daylily	dg	p	w	04-2																						x	p												
<i>Hemerocallis</i> 'All American Chief'	Daylily	dg	p	w	02-30																		x	x	x	p														
<i>Hemerocallis</i> 'All Fired Up'	Daylily	dg	p	e	01-5																		x	x	x	p														
<i>Hemerocallis</i> 'Always Afternoon'	Daylily	dg	p	i	01-2																		x	x	x	p														
<i>Hemerocallis</i> 'Apricot Sparkles'	Daylily	hl	p																							p														
<i>Hemerocallis</i> 'Apricot Sparkles'	Daylily	dg	p	m-e	01-5																						x	x	x	x										
<i>Hemerocallis</i> 'Apricot Sparkles'	Daylily	pg	p	06	s																						x	x	x	x	x									
<i>Hemerocallis</i> 'Apricot Symphony'	Daylily	dg	p	i	04-29																						x	x	x	p										
<i>Hemerocallis</i> 'Arctic Snow'	Daylily	dg	p	i	01-10																						x	x	x	p										
<i>Hemerocallis</i> 'Artaban'	Daylily	hl	p																																					
<i>Hemerocallis</i> 'Artaban'	Daylily	pg	p	15	n																																			

2010 Perennials in Bloom (Alpha Order of Botanical Name)

						Mar		Apr				May				June					July				Aug				Sept					Oct					
Botanical Name	Common Name	Garden	Type	Bed	Loc	Code	3	4	1	2	3	4	1	2	3	4	1	2	3	4	5	1	2	3	4	1	2	3	4	1	2	3	4	5	1	2	3	4	
<i>Hemerocallis</i> 'Attica'	Daylily	dg	p	e	02-13																	x	x	x	p														
<i>Hemerocallis</i> 'Aureole'	Daylily	dg	p	w	04-1																		x	p															
<i>Hemerocallis</i> 'Auspicious'	Daylily	dg	p	i	01-8																				x	p													
<i>Hemerocallis</i> 'Autumn Minaret'	Daylily	dg	p	i	08-29																																		
<i>Hemerocallis</i> 'Autumn Wood'	Daylily	dg	p	m-e	03-1																																		
<i>Hemerocallis</i> 'Baby Blues'	Daylily	dg	p	m-e	03-5																																		
<i>Hemerocallis</i> 'Barbara Mitchell'	Daylily	dg	p	i	03-18																																		
<i>Hemerocallis</i> 'Barometer Soup'	Daylily	dg	p	i	05-26																																		
<i>Hemerocallis</i> 'Beautiful Edgings'	Daylily	dg	p	i	04-26																																		
<i>Hemerocallis</i> 'Becky Lynn'	Daylily	dg	p	e	01-1																																		
<i>Hemerocallis</i> 'Becky Lynn'	Daylily	dg	p	i	02-9																																		
<i>Hemerocallis</i> 'Bela Lugosi'	Daylily	dg	p	i	04-30																																		
<i>Hemerocallis</i> 'Belle Isle Eye'	Daylily	dg	p	i	02-8																																		
<i>Hemerocallis</i> 'Bess Ross'	Daylily	dg	p	w	02-13																																		
<i>Hemerocallis</i> 'Betty Benz'	Daylily	dg	p	i	02-17																																		
<i>Hemerocallis</i> 'Betty Warren Woods'	Daylily	dg	p	i	01-25																																		
<i>Hemerocallis</i> 'Bible Story'	Daylily	hg	p	05	e	la																																	
<i>Hemerocallis</i> 'Big Smile'	Daylily	pg	p	04	w																																		
<i>Hemerocallis</i> 'Big Time Happy'	Daylily	dg	p	m-e	01-3																																		
<i>Hemerocallis</i> 'Bill Norris'	Daylily	dg	p	i	02-3																																		
<i>Hemerocallis</i> 'Bitsy'	Daylily	dg	p	m-w	01-3																																		
<i>Hemerocallis</i> 'Black Eyed Stella'	Daylily	dg	p	m-e	07-4																																		
<i>Hemerocallis</i> 'Black Eyed Stella'	Daylily	ec-n	p	04		la																																	
<i>Hemerocallis</i> 'Black Friar'	Daylily	dg	p	w	03-6																																		
<i>Hemerocallis</i> 'Blessing'	Daylily	dg	p	i	02-4																																		
<i>Hemerocallis</i> 'Bridgeton Bonus'	Daylily	dg	p	e	01-15																																		
<i>Hemerocallis</i> 'Bright and Cheerful'	Daylily	pg	p	07	n																																		
<i>Hemerocallis</i> 'Bright Dancer'	Daylily	pg	p	11	m	la																																	
<i>Hemerocallis</i> 'Broadway Accent'	Daylily	dg	p	m-e	01-9																																		
<i>Hemerocallis</i> 'Broadway Pink Slippers'	Daylily	dg	p	m-e	04-5																																		
<i>Hemerocallis</i> 'Brocaded Gown'	Daylily	dg	p	i	03-3																																		
<i>Hemerocallis</i> 'Brookwood Ojo POCO'	Daylily	dg	p	m-e	02-6																																		
<i>Hemerocallis</i> 'Brownstone'	Daylily	dg	p	w	03-3																																		
<i>Hemerocallis</i> 'Buckeye'	Daylily	dg	p	w	03-8																																		
<i>Hemerocallis</i> 'Bumblebee's Banquet'	Daylily	dg	p	m-e	02-7																																		
<i>Hemerocallis</i> 'Burning Daylight'	Daylily	dg	p	w	01-15																																		
<i>Hemerocallis</i> 'Calgary Stampede'	Daylily	pg	p	12	n	la																																	
<i>Hemerocallis</i> 'Cameroons'	Daylily	pg	p	06	s																																		
<i>Hemerocallis</i> 'Canadian Border Patrol'	Daylily	dg	p	i	03-7																																		
<i>Hemerocallis</i> 'Carrots Forever'	Daylily	dg	p	i	05-6																																		
<i>Hemerocallis</i> 'Catherine Woodbury'	Daylily	pg	p	03	e																																		
<i>Hemerocallis</i> 'Chance Encounter'	Daylily	dg	p	i	01-26																																		
<i>Hemerocallis</i> 'Charles Johnson'	Daylily	dg	p	i	03-13																																		
<i>Hemerocallis</i> 'Charmaine'	Daylily	pg	p	02	m																																		
<i>Hemerocallis</i> 'Chartreuse Magic'	Daylily	ec-n	p	04		map																																	

2010 Perennials in Bloom (Alpha Order of Botanical Name)

Botanical Name	Common Name	Garden	Type	Bed	Loc	Code	Mar				Apr				May				June					July				Aug				Sept					Oct								
							3	4	1	2	3	4	1	2	3	4	1	2	3	4	1	2	3	4	5	1	2	3	4	1	2	3	4	1	2	3	4	5	1	2	3	4			
<i>Hemerocallis</i> 'Evening Enchantment'	Daylily	pg	p	04	m																x	x	x	p																					
<i>Hemerocallis</i> 'Exalted Ruler'	Daylily	dg	p	i	04-1																																								
<i>Hemerocallis</i> 'Fairy Tale Pink'	Daylily	dg	p	e	02-3																																								
<i>Hemerocallis</i> 'Fairy Tale Pink'	Daylily	dg	p	i	01-5																																								
<i>Hemerocallis</i> 'Fairy Wings'	Daylily	dg	p	i	04-6																																								
<i>Hemerocallis</i> 'Fairy's Petitcoat'	Daylily	dg	p	m-e	02-8																																								
<i>Hemerocallis</i> 'Fat Lady Sings'	Daylily	dg	p	w	02-4																																								
<i>Hemerocallis</i> 'Feregi Gold'	Daylily	dg	p	i	01-18																																								
<i>Hemerocallis</i> 'Flamingo Fantasy'	Daylily	dg	p	i	02-28																																								
<i>Hemerocallis</i> 'Floribunda Rose'	Daylily	pg	p	05	e																																								
<i>Hemerocallis</i> 'Fooled Me'	Daylily	dg	p	i	01-23																																								
<i>Hemerocallis</i> 'Forsyth Hotlips'	Daylily	dg	p	i	02-2																																								
<i>Hemerocallis</i> 'Forsyth Summer Snow'	Daylily	dg	p	i	05-5																																								
<i>Hemerocallis</i> 'Francis of Assisi'	Daylily	dg	p	w	01-21																																								
<i>Hemerocallis</i> 'Frankie's Fantasy'	Daylily	hg	p	08	m	la																																							
<i>Hemerocallis</i> 'Frans Hals'	Daylily	pg	p	02	w	nl																																							
<i>Hemerocallis</i> 'Fred Stutz'	Daylily	dg	p	i	04-5																																								
<i>Hemerocallis</i> 'Full Reward'	Daylily	dg	p	w	03-1																																								
<i>Hemerocallis fulva</i> var. rosea	Daylily	hl	p																																										
<i>Hemerocallis</i> 'Galena Moon'	Daylily	pg	p	03	w																																								
<i>Hemerocallis</i> 'Gentle Ed'	Daylily	dg	p	i	05-2																																								
<i>Hemerocallis</i> 'Gladys Campbell'	Daylily	dg	p	e	01-4																																								
<i>Hemerocallis</i> 'Gold Dust'	Daylily	hl	p																																										
<i>Hemerocallis</i> 'Golden Bell'	Daylily	dg	p	w	02-28																																								
<i>Hemerocallis</i> 'Golden Orchid'	Daylily	dg	p	w	03-5																																								
<i>Hemerocallis</i> 'Golden Scroll'	Daylily	dg	p	w	01-23																																								
<i>Hemerocallis</i> 'Grace Buttercup'	Daylily	dg	p	m-e	04-4																																								
<i>Hemerocallis</i> 'Grape Velvet'	Daylily	dg	p	i	01-16																																								
<i>Hemerocallis</i> 'Great Goodness Gracious'	Daylily	dg	p	w	02-2																																								
<i>Hemerocallis</i> 'Great White'	Daylily	dg	p	e	01-11																																								
<i>Hemerocallis</i> 'Green Eyed Giant'	Daylily	pg	p	17	s																																								
<i>Hemerocallis</i> 'Green Flutter'	Daylily	dg	p	i	03-10																																								
<i>Hemerocallis</i> 'Green Shadows'	Daylily	pg	p	03	e																																								
<i>Hemerocallis</i> 'Happy Returns'	Daylily	dg	p	m-e	05-6																																								
<i>Hemerocallis</i> 'Happy Returns'	Daylily	ec-n	p	04		la																																							
<i>Hemerocallis</i> 'Heaven Bent'	Daylily	dg	p	w	01-16																																								
<i>Hemerocallis</i> 'Helen Shooter'	Daylily	dg	p	i	01-28																																								
<i>Hemerocallis</i> 'High on Purple'	Daylily	dg	p	i	07-29																																								
<i>Hemerocallis</i> 'Holly Dancer'	Daylily	dg	p	e	01-18																																								
<i>Hemerocallis</i> 'Hope Diamond'	Daylily	dg	p	i	01-13																																								
<i>Hemerocallis</i> 'Hopewell'	Daylily	dg	p	w	01-20																																								
<i>Hemerocallis</i> 'Hot Toddy'	Daylily	pg	p	07	n																																								
<i>Hemerocallis</i> 'Howdy'	Daylily	dg	p	w	02-24																																								
<i>Hemerocallis</i> 'Hyperion'	Daylily	hl	p																																										
<i>Hemerocallis</i> 'Hyperion'	Daylily	pg	p	01	n																																								
<i>Hemerocallis</i> 'Imprimatur'	Daylily	dg	p	i	02-12																																								
<i>Hemerocallis</i> 'Intense Orange Gold'	Daylily	dg	p	i	04-7																																								
<i>Hemerocallis</i> 'Irene Felix'	Daylily	dg	p	e	02-18																																								

2010 Perennials in Bloom (Alpha Order of Botanical Name)

Botanical Name	Common Name	Garden	Type	Bed	Loc	Code	Mar			Apr			May			June			July			Aug			Sept			Oct					
							3	4	1	2	3	4	1	2	3	4	1	2	3	4	1	2	3	4	1	2	3	4	1	2	3	4	
<i>Hemerocallis</i> 'Penny's Worth'	Daylily	dg	p	m-e	01-11										x	x	x	x	x	x	p												
<i>Hemerocallis</i> 'Perfect Pink Princess'	Daylily	dg	p	i	01-19															x	x	x	p										
<i>Hemerocallis</i> 'Perfect Pink Princess'	Daylily	dg	p	m-e	04-1															x	x	x	x										
<i>Hemerocallis</i> 'Petite'	Daylily	dg	p	w	02-7															x	x	x	x										
<i>Hemerocallis</i> 'Petite Lady Lilac'	Daylily	dg	p	m-e	01-6															x	x	x	p										
<i>Hemerocallis</i> 'Petra'	Daylily	dg	p	w	02-23															x	x	x	p										
<i>Hemerocallis</i> 'Pink Lavender Appeal'	Daylily	dg	p	e	02-6															x	x	x	p										
<i>Hemerocallis</i> 'Potentate'	Daylily	dg	p	w	02-17															x	p												
<i>Hemerocallis</i> 'Prairie Blue Eyes' (*White Temptation)	Daylily	dg	p	e	02-14																x	x	x										
<i>Hemerocallis</i> 'Prairie Charmer'	Daylily	dg	p	w	01-12															x	x	x	p										
<i>Hemerocallis</i> 'Prairie Thistle'	Daylily	dg	p	e	01-9																x	x	x	x									
<i>Hemerocallis</i> 'Prelude to Love'	Daylily	dg	p	i	02-15																x	x	x	x									
<i>Hemerocallis</i> 'Preppy Pink'	Daylily	dg	p	i	03-17																		x	x									
<i>Hemerocallis</i> 'Primal Scream'	Daylily	dg	p	e	01-17																x	x	x	p									
<i>Hemerocallis</i> 'Primula'	Daylily	dg	p	w	02-3																x	x	x	p									
<i>Hemerocallis</i> 'Private Secretary'	Daylily	dg	p	w	02-18																x	x	x	p									
<i>Hemerocallis</i> 'Prophet'	Daylily	dg	p	w	02-15																x	x	p										
<i>Hemerocallis</i> 'Pumpkin Kid'	Daylily	dg	p	i	01-6																x	x	x	x									
<i>Hemerocallis</i> 'Pure and Simple'	Daylily	dg	p	w	03-2																x	x	x	p									
<i>Hemerocallis</i> 'Rajah'	Daylily	hl	p																		x	x	p										
<i>Hemerocallis</i> 'Ram'	Daylily	dg	p	w	01-4																x	x	x	p									
<i>Hemerocallis</i> 'Rama'	Daylily	pg	p	04 e																	x	x	x										
<i>Hemerocallis</i> 'Raspberry Candy'	Daylily	dg	p	i	03-4																x	x	p										
<i>Hemerocallis</i> 'Raspberry Wine'	Daylily	dg	p	e	02-7																	x	p										
<i>Hemerocallis</i> 'Raspberry Wine'	Daylily	pg	p	07 n																	e	e	x	x	x								
<i>Hemerocallis</i> 'Red Aristocrat'	Daylily	pg	p	10 m		la																e	x	x									
<i>Hemerocallis</i> 'Red Razzle Dazzle'	Daylily	dg	p	i	03-21																	x	x	x	x								
<i>Hemerocallis</i> 'Red Volunteer'	Daylily	dg	p	i	04-2																x	x	x	x	p								
<i>Hemerocallis</i> 'Regency Heights'	Daylily	dg	p	w	02-22																			x	x								
<i>Hemerocallis</i> 'Riparian Entertainment'	Daylily	dg	p	i	03-6																			x	p								
<i>Hemerocallis</i> 'Romantic Returns'	Daylily	dg	p	i	01-24																x	x	x	x	p								
<i>Hemerocallis</i> 'Romona's Memory'	Daylily	dg	p	i	01-3																	x	x	x	p								
<i>Hemerocallis</i> 'Rose Basic'	Daylily	dg	p	i	04-4																	x	x	p									
<i>Hemerocallis</i> 'Rose Emily'	Daylily	dg	p	w	01-22																	x	x	x	p								
<i>Hemerocallis</i> 'Rosewitha'	Daylily	pg	p	05 w																			x	x									
<i>Hemerocallis</i> 'Rosy Returns'	Daylily	dg	p	m-e	01-10																x	x	x	x									
<i>Hemerocallis</i> 'Royal Ruby'	Daylily	dg	p	e	02-11																	x	x	x	x								
<i>Hemerocallis</i> 'Ruby Spider'	Daylily	dg	p	i	05-4																	x	x	p									
<i>Hemerocallis</i> 'Ruffled Apricot'	Daylily	dg	p	i	03-19																		x	p									
<i>Hemerocallis</i> 'Ruffled Parchment'	Daylily	dg	p	i	05-1																		x	x	x								
<i>Hemerocallis</i> 'Ruth Lehman'	Daylily	pg	p	09 m																	e	e	e	x	x								
<i>Hemerocallis</i> 'Sabine Bauer'	Daylily	dg	p	i	04-3																		x	p									
<i>Hemerocallis</i> 'Sacred Shield'	Daylily	dg	p	w	01-11																		x	x	x								
<i>Hemerocallis</i> 'Satin Glass'	Daylily	pg	p	08 m																		e	e	e	x								
<i>Hemerocallis</i> 'Scarlet Orbit'	Daylily	dg	p	i	02-7																		x	p									
<i>Hemerocallis</i> 'Sea Gold'	Daylily	pg	p	08 e																		e	e	e	x	x	p						

2010 Perennials in Bloom (Alpha Order of Botanical Name)

Botanical Name	Common Name	Garden	Type	Bed	Loc	Code	Mar		Apr		May		June		July		Aug		Sept		Oct	
							3	4	1	2	3	4	1	2	3	4	1	2	3	4	1	2
<i>Hemerocallis</i> 'Thunbergs'	Daylily	hl	p													x	x	p				
<i>Hemerocallis</i> 'Tigerling'	Daylily	dg	p	m-e	06-4											x	x	x				
<i>Hemerocallis</i> 'Tonkin'	Daylily	pg	p	05	w											x	x	x				
<i>Hemerocallis</i> 'Trahyta'	Daylily	dg	p	i	04-28											x	x	x	p			
<i>Hemerocallis</i> 'Tralee'	Daylily	pg	p	08	w									e	x	x	x	x	p			
<i>Hemerocallis</i> 'Vanilla Fluff'	Daylily	dg	p	w	03-7											x	x	p				
<i>Hemerocallis</i> 'Vera Biaglow'	Daylily	dg	p	w	02-11											x	x	x	p			
<i>Hemerocallis</i> 'Warren Treadwell'	Daylily	dg	p	w	02-26											x	x	x				
<i>Hemerocallis</i> 'Wedding Band'	Daylily	dg	p	i	02-16											x	x	x	p			
<i>Hemerocallis</i> 'White Formal'	Daylily	pg	p	11	w	la										x	x					
<i>Hemerocallis</i> 'White Triangle'	Daylily	dg	p	w	02-8											x	x	x				
<i>Hemerocallis</i> 'Wild Mustang'	Daylily	pg	p	10	e	la										e	x	x	x			
<i>Hemerocallis</i> 'Wineberry Candy'	Daylily	dg	p	w	01-8											x	x	x	p			
<i>Hemerocallis</i> 'Winning Ways'	Daylily	dg	p	w	02-19											x	x	p				
<i>Hemerocallis</i> 'Winsome'	Daylily	hl	p										x	x	x	p						
<i>Hemerocallis</i> 'Woodside Amethyst'	Daylily	dg	p	w	02-25											x	x	x	p			
<i>Hemerocallis</i> 'Woodside Fantasy'	Daylily	dg	p	m-e	01-4											x	x	x	p			
<i>Hemerocallis</i> 'Woodside Romance'	Daylily	dg	p	w	01-24											x	x	x	p			
<i>Hemerocallis</i> 'Yazoo Elzie Hinton'	Daylily	dg	p	w	02-31											x	x	x				
<i>Hemerocallis</i> 'Yellow Explosion'	Daylily	dg	p	i	02-26											x	x	x				
<i>Hemerocallis</i> 'You Angel You'	Daylily	dg	p	m-w	01-1											x	x	x	p			
<i>Hepatica acutiloba</i>	Liverwort	hg	p	12	e	la			x	x												
<i>Heuchera</i> 'Amethyst Myst'	Coral Bells	pg	p	12	s	la										x	p	p	p			
<i>Heuchera</i> 'Amethyst Myst'	Coral Bells	pg	p	11	e											x	x	p				
<i>Heuchera</i> 'Can Can'	Coral Bells	pg	p	09	e							e	e	e	x							
<i>Heuchera</i> 'Dolce Blackcurrant'	Coral Bells	pg	p	14	m								e	e	x	x	x	p				
<i>Heuchera</i> 'Green Spice'	Coral Bells	pg	p	11	w	la										p	p					
<i>Heuchera</i> 'Marmalade'	Coral Bells	pg	p	13	e											e	x	x	p			
<i>Heuchera micrantha</i> 'Palace Purple'	Coral Bells	pg	p	14	w											e	e	e	x	x	x	p
<i>Heuchera micrantha</i> 'Chocolate Ruffles'	Coral Bells	ec-n	p	04		la										e	e	x	x	x		
<i>Heuchera</i> 'Midnight Rose'	Coral Bells	ec-n	p	01		la										e	e	x	x	x	p	
<i>Heuchera</i> 'Mocha Mint'	Coral Bells	pg	p	06	n											e	e	x	x	x	p	p
<i>Heuchera</i> 'Montrose Ruby'	Coral Bells	pg	p	08	e											e	e	e	x			
<i>Heuchera</i> 'Newest Hybrids'	Alumroot	pg	p	04	e											e	x	x	x	x	p	p
<i>Heuchera</i> 'Obsidian'	Coral Bells	ec-n	p	06		la										e	x	x	x			
<i>Heuchera</i> 'Obsidian'	Coral Bells	pg	p	13	e											e	e	x	p			
<i>Heuchera</i> 'Palace Purple Select'	Coral Bells	pg	p	08	e														e	x		
<i>Heuchera</i> 'Palace Purple Select'	Coral Bells	pg	p	09	e											e	e	x				
<i>Heuchera</i> 'Palace Purple Select'	Coral Bells	pg	p	11	w	la													p	p		
<i>Heuchera</i> 'Peppermint Spice'	Coral Bells	ec-s	p	sbs		la										e	e	x	x	x	x	
<i>Heuchera</i> 'Peppermint Spice'	Coral Bells	pg	p	03												e	x	x				
<i>Heuchera</i> 'Purple Petticoats'	Coral Bells	pg	p	12	s	la												e	e	p		
<i>Heuchera richardsonii</i>	Coral Bells	pg	p	03	e											e	e	x	x	x	p	
<i>Heuchera sanguinea</i> 'Rosamundi'	Coral Bells	pg	p	10	m	la										e	e	x	x	x	p	p
<i>Heuchera sanguinea</i> 'Rosamundi'	Coral Bells	pg	p	11	e	la										e	x	x	x	p		
<i>Heuchera</i> 'Sashay'	Coral Bells	ec-n	p	01		la										e	x	x	x	x	x	x
<i>Heuchera villosa</i> 'Purpurea'	Hairy Alumroot	pg	p	13	b													e	e	x	x	p
<i>Heuchera x brizoides</i>	Hybrid Coral Bells	pg	p	10	e	la										e	e	x	x	x	p	
<i>Heuchera x brizoides</i>	Hybrid Coral Bells	pg	p	15	m											e	x	x	x	x	x	p

2010 Perennials in Bloom (Alpha Order of Botanical Name)

Botanical Name	Common Name	Garden	Type	Bed	Loc	Code	Mar				Apr				May				June				July				Aug				Sept				Oct								
							3	4	1	2	3	4	1	2	3	4	1	2	3	4	1	2	3	4	1	2	3	4	1	2	3	4	1	2	3	4	1	2	3	4			
<i>Hosta</i> 'Elvis Lives'		pg	p	09	w												e	e	x	x	x	x	p	p																			
<i>Hosta</i> 'Emerald Necklace'		pg	p	08	m																e	x																					
<i>Hosta</i> 'English Sunrise'		pg	p	14	w																	e	x	x	x	p																	
<i>Hosta fortunei</i> 'Gigantea'		rg	p	i-e	n													x	x	x	x																						
<i>Hosta</i> 'Francee'		pg	p	16	ne																			x	p																		
<i>Hosta</i> 'Fried Green Tomatoes'		rg	p	w																			x	x	x	x											x						
<i>Hosta</i> 'Fringe Benefit'		pg	p	09	w																e	x	x	p																			
<i>Hosta</i> 'Frosted Dimples'		pg	p	11	w	la																	e	x	x																		
<i>Hosta</i> 'Geneva Stark'		pg	p	11	m	la																	e	e	x	p																	
<i>Hosta</i> 'Ginko Craig'		pg	p	09	e																																						
<i>Hosta</i> 'Golden Circles'		pg	p	07	s													e	x	x																							
<i>Hosta</i> 'Grand Prize'		pg	p	14	w																		e	x	x	p																	
<i>Hosta</i> 'Great Arrival'		sm-west	p	w	s	la																	x	x	p																		
<i>Hosta</i> 'Great Expectations'		pg	p	07	n													e	e	x	x	x																					
<i>Hosta</i> 'Green Fountain'		pg	p	15	n																																						
<i>Hosta</i> 'Green Wedge'		pg	p	08	e																		e	x	x	p	p																
<i>Hosta</i> 'Ground Master'		gh	p	nw																																							
<i>Hosta</i> 'Guacamole'		rg	p	w																				x	x	x	x																
<i>Hosta</i> 'Guardian Angel'		pg	p	11	e	la																	x	x	c																		
<i>Hosta</i> 'Guilt by Association'		ec-n	p	06	la																																						
<i>Hosta</i> 'Gypsy Rose'		pg	p	11	m	la																																					
<i>Hosta</i> 'Hadspen Blue'		pg	p	15	n																																						
<i>Hosta</i> 'Halcyon'		pg	p	09	m																																						
<i>Hosta</i> 'Heartsong'		ec-n	p	01	la																																						
<i>Hosta</i> 'Heavenly Tiara'		pg	p	06	n																																						
<i>Hosta</i> 'Helonioides Albopicta'		pg	p	06	m																																						
<i>Hosta</i> 'Hercules'		pg	p	14	w																																						
<i>Hosta</i> 'Holly's Honey'		pg	p	08	m																																						
<i>Hosta</i> 'Holly's Velvet Piecrust'		pg	p	14	w																																						
<i>Hosta</i> 'Holy Mole'		rg	p	cw-e																																							
<i>Hosta</i> 'Honeybells'		rg	p	w-st																																							
<i>Hosta</i> 'Honeybells'		sm-west	p	w	s	la																																					
<i>Hosta</i> 'Hoosier Harmony'		ec-n	p	01	la																																						
<i>Hosta</i> 'I'm So Blue'		ec-n	p	06	la																																						
<i>Hosta</i> 'Invincible'		rg	p	i-e	s																																						
<i>Hosta</i> 'Jason and Katie'		pg	p	11	w	la																																					
<i>Hosta</i> 'June'		pg	p	08	e																																						
<i>Hosta</i> 'Katie Q'		pg	p	11	w	la																																					
<i>Hosta</i> 'Komodo Dragon'		pg	p	12	s	la																																					
<i>Hosta</i> 'Lacy Belle'		ec-n	p	01	la																																						
<i>Hosta</i> 'Lakeside Blue Jeans'		ec-n	p	06	la																																						
<i>Hosta</i> 'Lakeside Kaleidoscope'		pg	p	14	w																																						
<i>Hosta</i> 'Lakeside Lollipop'		pg	p	15	n																																						
<i>Hosta</i> 'Lakeside Roy El'		ec-n	p	06	la																																						
<i>Hosta</i> 'Lakeside Shockwave'		ec-n	p	06	la																																						
<i>Hosta</i> 'Lakeside Surf Rider'		ec-n	p	06	la																																						
<i>Hosta</i> 'Lakeside Tycoon'		ec-n	p	01	la																																						
<i>Hosta lancifolia</i>		pg	p	07	s																																						
<i>Hosta lancifolia</i>		rg	p	e																																							
<i>Hosta</i> 'Leather Sheen'		pg	p	06	s																																						
<i>Hosta</i> 'Lederhosen'		rg	p	cw-e																																							
<i>Hosta</i> 'Lemon Frost'		pg	p	09	w																																						
<i>Hosta</i> 'Lochness Monster'		ec-n	p	06	la																																						
<i>Hosta</i> 'Love Pat'		pg	p	07	n																																						
<i>Hosta</i> 'Loyalist'		pg	p	11	w	la																																					
<i>Hosta</i> 'Majesty'		ec-n	p	01	la																																						
<i>Hosta</i> 'Mama Mia'		ec-n	p	01	la																																						
<i>Hosta</i> 'Manhattan'		ec-n	p	06	la																																						
<i>Hosta</i> 'Midas Touch'		pg	p	08	m																																						
<i>Hosta</i> 'Miss Saigon'		rg	p	e-st	w																																						
<i>Hosta</i> 'Mississippi Delta'		ec-n	p	06	la																																						

2010 Perennials in Bloom (Alpha Order of Botanical Name)

Botanical Name	Common Name	Garden	Type	Bed	Loc	Code	Mar				Apr				May				June					July				Aug					Sept					Oct			
							3	4	1	2	3	4	1	2	3	4	1	2	3	4	1	2	3	4	5	1	2	3	4	1	2	3	4	1	2	3	4	1	2	3	4
<i>Iris</i> 'Fathom'	Intermediate Bearded	sm-west	p	w	m	la																																			
<i>Iris</i> 'Fran Jennings'	Standard Dwarf Bearded	ig	p		24								x	x	p	p																									
<i>Iris</i> 'From the Heart'	Intermediate Bearded	sm-east	p	e	n	la									x	p																									
<i>Iris</i> 'Fuchsia Frills'	Tall Bearded	pg	p	04	w										x	x	x																								
<i>Iris</i> 'Fuji Skies'	Tall Bearded	pg	p	10	m	la																																			
<i>Iris</i> 'Full Fashioned'	Tall Bearded	pg	p	10	e	la											e	x																							
<i>Iris</i> 'Funtime'	Standard Dwarf Bearded	ig	p		12								e	x	x	p	p																								
<i>Iris</i> 'Gaily Golden'	Intermediate Bearded	sm-east	p	e	n	la									e	x	x	p																							
<i>Iris</i> 'Gallant Moment'	Tall Bearded	pg	p	08	w												e	x																							
<i>Iris</i> 'Galleon Gold'	Standard Dwarf Bearded	ig	p		02											e	x	x	p	p																					
<i>Iris</i> 'Gay Parasol'	Tall Bearded	pg	p	08	w												x	x																							
<i>Iris</i> 'Gay Wings'	Intermediate Bearded	sm-west	p	w	m	la											e	x	p																						
<i>Iris</i> 'Gingerbread Man'	Standard Dwarf Bearded	ig	p		04											e	x	p	p	p																					
<i>Iris</i> 'Glory Bound'	Tall Bearded	pg	p	04	w												x	x	x																						
<i>Iris</i> 'God's Handwork'	Tall Bearded	pg	p	03	e											e	x	x	p																						
<i>Iris</i> 'Gospel Changes'	Tall Bearded	pg	p	05	w												x	x	x																						
<i>Iris graminea</i>	Dwarf Spuria Iris?	rg	p	cw-e															x																						
<i>Iris graminea</i>	Plum Tart Iris	hg	p	08	w	la												x																							
<i>Iris</i> 'Grand Waltz'	Tall Bearded	pg	p	10	m	la													e	x																					
<i>Iris</i> 'Gypsy Romance'	Tall Bearded	pg	p	02	w												x	x	p																						
<i>Iris</i> 'Gyro'	Tall Bearded	pg	p	10	e	la												x	p	p																					
<i>Iris</i> 'Hagar's Helmet'	Intermediate Bearded	sm-east	p	e	n	la											e	x	x	p																					
<i>Iris</i> 'Halo in Orange'	Tall Bearded	pg	p	04	e																																				
<i>Iris</i> 'Hindenberg'	Tall Bearded	pg	p	03	w												e	x	x	p																					
<i>Iris histrioides</i> 'George' (purple)	Minature Iris	ec-s	p	02		la				x																															
<i>Iris</i> 'Holy Night'	Tall Bearded	pg	p	03	w												e	x	p																						
<i>Iris</i> 'Honky Tonk Blues'	Tall Bearded	pg	p	04	e														x	x																					
<i>Iris</i> 'Hot Fudge'	Intermediate Bearded	sm-east	p	e	n	la											e	x	x	p																					
<i>Iris</i> 'Humoresque'	Tall Bearded	pg	p	02	e												x	x	p																						
<i>Iris</i> 'Infinity Ring'	Intermediate Bearded	sm-east	p	e	m	la												x	x	p																					
<i>Iris</i> 'Jesse's Song'	Tall Bearded	pg	p	05	w													e	x	x																					
<i>Iris</i> 'Joyce Terry'	Tall Bearded	pg	p	05	m														x																						
<i>Iris</i> 'Jurassic Park'	Tall Bearded	pg	p	02	w														e	x	p																				
<i>Iris</i> 'Keeping Up Appearances'	Tall Bearded	pg	p	06	s														x	x																					
<i>Iris</i> 'Kingfisher Blue'	Kingfish Blue Iris?	rg	p	cw-w																x																					
<i>Iris</i> 'Knotty Pine'	Standard Dwarf Bearded	ig	p		13																																				
<i>Iris</i> 'Laced Cotton'	Tall Bearded	pg	p	11	w	la																																			
<i>Iris</i> 'Lady Friend'	Tall Bearded	pg	p	12	n	la																																			
<i>Iris</i> 'Lady in Red'	Standard Dwarf Bearded	ig	p		03																																				
<i>Iris</i> 'Lake Placid'	Tall Bearded Iris	ec-s	p	sbs		nl													e	e	x	p																			
<i>Iris</i> 'Larcenist'	Tall Bearded	pg	p	05	m															x	x	x																			
<i>Iris</i> 'Light Calvary'	Intermediate Bearded	sm-west	p	w	s	la													e	x	p																				
<i>Iris</i> 'Like a Charm'	Intermediate Bearded	sm-west	p	w	n	la																																			
<i>Iris</i> 'Lillipinkput'	Intermediate Bearded	sm-west	p	w	m	la														e	x	p																			
<i>Iris</i> 'Limonada'	Intermediate Bearded	sm-west	p	w	s	la																																			
<i>Iris</i> 'Little Sapphire'	Standard Dwarf Bearded	ig	p		20														x	p	p	p																			
<i>Iris</i> 'Loving Touch'	Intermediate Bearded	sm-east	p	ne	n	la													e	x	x	x	p																		
<i>Iris</i> 'Made of Magic'	Tall Bearded	pg	p	05	w																																				
<i>Iris</i> 'Magical Encounter'	Tall Bearded	pg	p	02	w																																				
<i>Iris</i> 'Maroon Caper'	Intermediate Bearded	sm-west	p	nw		la																																			

2010 Perennials in Bloom (Alpha Order of Botanical Name)

Botanical Name	Common Name	Garden	Type	Bed	Loc	Code	Mar				Apr				May				June					July				Aug				Sept					Oct			
							3	4	1	2	3	4	1	2	3	4	1	2	3	4	1	2	3	4	5	1	2	3	4	1	2	3	4	5	1	2	3	4		
<i>Iris</i> 'Mary D'	Tall Bearded	pg	p	03	e												e	x	x	p																				
<i>Iris</i> 'Mary Frances'	Tall Bearded	pg	p	06	s																x	x																		
<i>Iris</i> 'Midnight Express'	Tall Bearded	pg	p	08	e																x	x	x																	
<i>Iris</i> 'Midsummer Night's Dream'	Intermediate Bearded	sm-west	p	w	m	la											e	x	x	p																				
<i>Iris</i> 'Ming'	Intermediate Bearded	sm-west	p	w	s	la																																		
<i>Iris</i> 'Mini Dragon'	Standard Dwarf Bearded	ig	p			08							e	x	p	p																								
<i>Iris</i> 'Moon Shadows'	Standard Dwarf Bearded	ig	p			06							e	x	x	p	p																							
<i>Iris</i> 'Mrs. Nate Rudolph'	Standard Dwarf Bearded	ig	p			09											x	x	p	p																				
<i>Iris</i> 'Mystic Mood'	Tall Bearded Iris	ec-s	p	sbs		la															x	x	p																	
<i>Iris</i> 'Neil Diamond'	Tall Bearded	pg	p	10	w	nl																																		
<i>Iris</i> 'Nipmuc'	Standard Dwarf Bearded	ig	p			25							e	x	p	p																								
<i>Iris</i> 'Noble Spirit'	Tall Bearded	pg	p	03	m	nn															x	x	p																	
<i>Iris</i> 'Obligato'	Intermediate Bearded	sm-east	p	e	s	la															x	x	x	p																
<i>Iris</i> 'Ohio Deb'	Intermediate Bearded	sm-west	p	w	n	la															x	x	p																	
<i>Iris</i> 'Oklahoma Bandit'	Intermediate Bearded	sm-west	p	w	s	la																																		
<i>Iris</i> 'Orange Capers'	Standard Dwarf Bearded	ig	p			21															x	x	p	p																
<i>Iris</i> 'Orange Slices'	Tall Bearded	pg	p	03	w																			e	x	p														
<i>Iris</i> 'Painted Hills'	Intermediate Bearded	sm-east	p	e	n	la															e	x	x	p																
<i>Iris</i> 'Panther'	Standard Dwarf Bearded	ig	p			28															x	x	p	p																
<i>Iris</i> 'Peachy Face'	Intermediate Bearded	sm-east	p	e	n	la																	e	x	p															
<i>Iris</i> 'Pele'	Standard Dwarf Bearded	ig	p			17																	x	x	p	p														
<i>Iris</i> 'Persian Morn'	Tall Bearded	pg	p	05	m																					x	x													
<i>Iris</i> 'Pink Kitten'	Intermediate Bearded	sm-east	p	e	s	la																	e	x	x	p														
<i>Iris</i> 'Pinky Paws'	Standard Dwarf Bearded	ig	p			19																	x	x	p	p														
<i>Iris</i> 'Piping Hot'	Tall Bearded	pg	p	10	e	la																				x	x	x												
<i>Iris</i> 'Pixie Pastel'	Standard Dwarf Bearded	ig	p			07																	e	x	p	p														
<i>Iris</i> 'Posy Parade'	Intermediate Bearded	sm-east	p	ne	n	la																																		
<i>Iris</i> 'Pot Luck'	Intermediate Bearded	sm-west	p	w	n	la																																		
<i>Iris</i> 'Prank'	Standard Dwarf Bearded	ig	p			23																																		
<i>Iris</i> 'Prestige Item'	Tall Bearded	pg	p	05	e																																			
<i>Iris</i> 'Queen's Circle'	Tall Bearded	pg	p	07	n																																			
<i>Iris</i> 'Rare Edition'	Intermediate Bearded	sm-east	p	ne	n	la																																		
<i>Iris</i> 'Razzle Dazzle'	Standard Dwarf Bearded	ig	p			15																																		
<i>Iris</i> 'Red Reward'	Tall Bearded	pg	p	11	w	la																																		
<i>Iris</i> 'Red Zinger'	Intermediate Bearded	sm-west	p	w	m	la																																		
<i>Iris reticulata</i> (dark blue/purple)	Minature Iris	ec-s	p	02		la																																		
<i>Iris reticulata</i> 'Natascha' (white)	Minature Iris	ec-s	p	02		la																																		
<i>Iris reticulata</i> 'Springtime' (blue)	Minature Iris	ec-s	p	02		la																																		
<i>Iris</i> 'Rimaround'	Intermediate Bearded	sm-west	p	w	m	la																																		
<i>Iris</i> 'Ringo'	Tall Bearded	pg	p	04	e																																			
<i>Iris</i> 'Royal Touch'	Tall Bearded	pg	p	03	e																																			
<i>Iris</i> 'Ruby Chimes'	Intermediate Bearded	sm-east	p	e	n	la																																		
<i>Iris</i> 'Ruby Slippers'	Intermediate Bearded	sm-west	p	w	n	la																																		

2010 Perennials in Bloom (Alpha Order of Botanical Name)

Botanical Name	Common Name	Garden	Type	Bed	Loc	Code	Mar				Apr				May				June				July				Aug				Sept				Oct					
							3	4	1	2	3	4	1	2	3	4	1	2	3	4	1	2	3	4	5	1	2	3	4	1	2	3	4	1	2	3	4	5	1	2
<i>Iris</i> 'Victoria Falls'	Tall Bearded	pg	p	05	e												x	x																						
<i>Iris</i> 'Victorian Parlor'	Intermediate Bearded	sm-east	p	e	n	la									e	x	x	p																						
<i>Iris virginica</i> var. <i>shrevei</i>	Interior Iris	rg	p	cw-w																				x																
<i>Iris</i> 'Visa'	Intermediate Bearded	sm-east	p	e	n	la												p																						
<i>Iris</i> 'Voila'	Intermediate Bearded	sm-east	p	e	m	la										x	x	p																						
<i>Iris</i> 'Wedding Candles'	Tall Bearded	pg	p	10	w	la											x	x	p																					
<i>Iris</i> 'Wench'	Tall Bearded	pg	p	01													e	e	p																					
<i>Iris</i> 'Western Tradition'	Tall Bearded	pg	p	08	w													x																						
<i>Iris</i> 'World Premier'	Tall Bearded	pg	p	02	w	nn											e	x	x	p																				
<i>Iris</i> x <i>germanica</i> var. <i>florentina</i>	Orris	hg	p	08	w	la											x	x	p																					
<i>Iris</i> 'Yaquina Blue'	Tall Bearded	pg	p	08	e													x	x	x																				
<i>Isatis tinctoria</i>	Dyer's Woad	hg	p	11	m	la									x	x	x																							
<i>Itea virginica</i> 'Henry's Garnet'	Virginia Sweetspire	ec-s	w	sbn		la											x	x	p																					
<i>Jeffersonia diphylla</i>	American Twinleaf	pg	p	15	n						x	x	p																											
<i>Kalimeris pinnatifida</i> (<i>Asteromoea mongolica</i>)	Japanese Aster	pg	p	06	m																			e	x															
<i>Kalimeris yomena</i> 'Shogun'	Japanese Aster	pg	p	08	wf																								x											
<i>Kerria japonica</i>	Japanese Kerria	sm-east	p	e	s	la								e	x	x	x	p																						
<i>Kerria japonica</i> 'Golden Guinea'	Japanese Kerria	ec-n	w	01		la								e	x	x	x	x	p					x	x	x														
<i>Kirengeshoma koreana</i>	Korean Yellow Waxbells	pg	p	15	n																			e	e	e	e	e	e	e	e	e	x	p						
<i>Kirengeshoma palmata</i>	Yellow Waxbells	pg	p	11	m	la																						e	e	e	e	e	e	e	e	x				
<i>Kirengeshoma palmata</i>	Yellow Waxbells	rg	p	cw-e																			x	x	x	x						x	x	x						
<i>Knautia macedonica</i> 'Dark Red'	Knautia	pg	p	04	w																		e	x	x	x	x	x		x		x	x	x	x	x	x			
<i>Knautia macedonica</i> 'Melton Pastels'	Knautia	pg	p	04	w												e	x	x	x	p	p	p	p	p	p	p	p												
<i>Kniphofia triangularis</i>	Mandarine Poker	ec-s	p	05																																x	x	x		
<i>Kniphofia triangularis</i>	Torch Flower	pg	p	02	m																							x	x	p							r	p		
<i>Kolkwitzia amabilis</i>	Beautybush	sm-east	w	e	s	la												x	x	p																				
<i>Lamiastrum galeobdolon</i> 'Herman's Pride'	Dead Nettle	sm-west	p	s	s	la												e	x	x	p																			
<i>Lamium</i> 'White Nancy'	Sweet Nettle	rg	p	i-e	n						e	e	x	x	x	x	x	x	x	x	x	x	x																	
<i>Lamium maculata</i> 'Chequers'	Dead Nettle	hg	p	arb	pw2	la												x	x	x	x	x	x	x	x	x	x	x		x				x	x	x	x	x		
<i>Lamium maculatum</i> 'Pink Chablis'	Spotted Nettle	pg	p	17	sb						e	e	x	x	x	x	p																							
<i>Lamium</i> 'Pink Chablis'	Dead Nettle	ec-n	p	06		nl								e	e	e	e	e	e	x	x	x	x	x	x	x	x	p	p											
<i>Larkspur</i> 'Blue Cloud'		sm-east	p	e	n	la																		e	x	x	x	x	x	x	p									
<i>Lathyrus vernus</i>	Spring Vetch	rg	p	cw-e										e	x	x	x	p																						
<i>Lavandula angustifolia</i>	Lavender	hg	p	08	m	la																	e	x	x	x	x	p												
<i>Lavandula angustifolia</i> 'Melissa'	Lavender	hg	p	08	w	la																						x	p											
<i>Lavandula</i> 'Garden Leader'	Lavender	pg	p	10	w	la																	x	x	x	x	x	p	p		e	x	x	x	x	x	x	x	x	
<i>Lavandula</i> 'Garden Leader'	Lavender	pg	p	04	w																		e	e	x	x	p													
<i>Lavandula</i> 'La Vance'	Lavender	hg	p	08	e	la																	e	x	x	x	x	x	x	x	x	x	x	x	x	x	x	p		
<i>Lavandula</i> 'Vincenza Blue'	Lavender	pg	p	11	w	la																		x	x	x	p						e	e	e	x	x	x	x	p
<i>Lespedeza thunbergii</i> 'Edo Shitori'	Bush Clover	pg	p	11	e	la																											e	e	e	x	x	p	p	p
<i>Lespedeza thunbergii</i> 'Gibraltar'	Bush Clover	ec-n	p	01		la																											e	x	x	x	x	p		
<i>Leucanthemum vulgare</i> 'May Queen' ('Maikoinigin')	Ox-Eye Daisy	pg	p	05	w																		e	x	x	x	p													
<i>Leucanthemum vulgare</i> 'Rheinblick'	Ox-Eye Daisy	pg	p	10	w	la																	e	x	x	x	x	p	p											
<i>Leucanthemum x superbum</i> 'Becky'	Shasta Daisy	pg	p	02	w																		e	e	e	x	x	x	x	p										
<i>Leucanthemum x superbum</i> 'Becky'	Shasta Daisy	pg	p	05	w																						e	x	x	x	x	p								
<i>Leucanthemum x superbum</i> 'Becky'	Shasta Daisy	ec-s	p	sbn		la																					x					x	x	p	p	r	r	r		
<i>Leucanthemum x superbum</i> 'Nordlicht'	Shasta Daisy	pg	p	03	w																		e	e	x	x	p													
<i>Leucanthemum x superbum</i> 'Snow Lady'	Shasta Daisy	pg	p	03	ef																		e	e	e	x	x	x	p							r	r	r	r	p

2010 Perennials in Bloom (Alpha Order of Botanical Name)

Botanical Name	Common Name	Garden	Type	Bed	Loc	Code	Mar		Apr		May		June		July		Aug		Sept		Oct					
							3	4	1	2	3	4	1	2	3	4	1	2	3	4	1	2	3	4	1	2
<i>Lysimachia clethroides</i>	Gooseneck Loosestrife	pg	p	05	e	nl									e	x	x	x	p							
<i>Macleaya cordata</i>	Plum Poppy	hg	p	09	w	la									x	x	x	p								
<i>Magnolia stellata</i> 'Kikuzaki'	Star Magnolia	ec-n	w	06		la	x	x	x																	
<i>Magnolia stellata</i> 'Kikuzaki'	Star Magnolia	ec-s	w	fee	by EC	la			x	x																
<i>Magnolia stellata</i> 'Royal Star'	Star Magnolia	ec-s	w	02		la	x	x	x																	
<i>Magnolia x soulangiana</i> 'Lenei'	Saucer Magnolia	pg	w	02	e				x	p	r	r	p													
<i>Mahonia aquifolium</i> 'Flame'	Oregon Grape Holly	pg	w	01	e				e	x	x	p														
<i>Malus</i> 'Molten Lava'	Flowering Crabapple	ec-s	w	12		la				e	e	x	p													
<i>Malus</i> 'Select A'	Firebird™ Crabapple	sm-east	w	ne	n	la					e	x	p													
<i>Malus</i> 'Select A'	Firebird™ Crabapple	sm-west	w	nw		la					x	x	p													
<i>Malus</i> spp. 'McIntosh'	Apple	hg	w	08	w							e														
<i>Malus x zumi</i> 'Calacarpa'	Flowering Crabapple	ec-n	p	01		la						e	x	p												
<i>Marrubium vulgare</i>	Horehound	hg	p	02	e	la							x	x	x											
<i>Mentha aquatica</i> var. <i>crispa</i>	Curly Mint	hg	p	08	w	la								e	e	x	x	x	x	x	p					
<i>Mentha longifolia</i>	Horsemint	hg	p	05	n	la										e	x	x	p							
<i>Mentha x piperita</i>	Peppermint	hg	p	02	n	la									x	x	x	x	x	x		x	x			
<i>Mertensia virginica</i>	Virginia Bluebells	pg	p	13	bb	nl		x	x	x	x	p														
<i>Mertensia virginica</i>	Virginia Bluebells	pg	p	07	sb	nl		e	x			x	x													
<i>Mertensia virginica</i>	Virginia Bluebells	rg	p	w	m			x	x	x	x	x	p													
<i>Mespilus germanica</i> 'Marron'	Medlar	hg	p	ci	m	la							x	x												
<i>Miscanthus purpurascens</i> 'Herkules'	Silver Grass	ec-s	p	05		la															x	x	x	x	x	x
<i>Miscanthus sinensis</i> 'Adagio'	Maiden Grass	pg	p	06	m																	x	x			
<i>Miscanthus sinensis</i> 'Ferner Osten'	Eulalia Grass	ec-n	p	01		la									e	x	x	x	x	x	x	x	x	x	x	x
<i>Miscanthus sinensis</i> 'Ferner Osten'	Maiden Grass	gh	p	w													x	x	x	x	x	x	x	x		
<i>Miscanthus sinensis</i> 'Graziella'	Eulalia Grass	ec-n	p	few		la											x	x	x	x	x	x	x	x	x	
<i>Miscanthus sinensis</i> 'Grosse Fontane'	Japanese Silver Grass	ec-n	p	01		la															x	x	x	x	x	
<i>Miscanthus sinensis</i> 'Malepartus'	Maiden Grass	pg	p	06	m																	x	x			
<i>Miscanthus sinensis</i> 'Neue Hybriden' (syn. 'New Hybrids')	Eulalia Grass	pg	p	11	m	la																	x	x	x	
<i>Miscanthus sinensis</i> 'Puenktchen' (syn. 'Little Dot')	Japanese Silver Grass	pg	p	02	eb																	x	x	x	x	
<i>Miscanthus sinensis</i> 'Purpurascens'	Eulalia Grass	ec-s	p	05		la															x	x	x	x	x	
<i>Miscanthus sinensis</i> 'Silberfeder' (syn. 'Silver Feather')	Japanese Silver Grass	pg	p	17	mb																e	x	x	x	x	
<i>Miscanthus sinensis</i> 'Silberfeder' (syn. 'Silver Feather')	Japanese Silver Grass	pg	p	14	e																	x	x	x	x	
<i>Miscanthus sinensis</i> 'Strictus'	Porcupine Grass	pg	p	04	m																		x	x	x	
<i>Miscanthus sinensis</i> 'Variegatus'	Japanese Silver Grass	pg	p	14	w																		x	x	x	
<i>Miscanthus sinensis</i> 'Yaku Jima'	Japanese Silver Grass	pg	p	13	ee																			x	x	
<i>Molinia caerulea</i> 'Bergfreund' (syn. 'Friend of the Mountain')	Tall Purple Moor Grass	ec-n	p	01		la									e	x	x	x	x	x	x	x	x	x	x	
<i>Molinia caerulea</i> 'Dauerstrahl'	Purple Moor Grass	ec-n	p	01		la									e	x	x	x	x	x	x	x	x	x	x	
<i>Molinia caerulea</i> 'Heidebraut'	Purple Moor Grass	ec-n	p	01		la									e	x	x	x	x	x	x	x	x	x	x	

2010 Perennials in Bloom (Alpha Order of Botanical Name)

Botanical Name	Common Name	Garden	Type	Bed	Loc	Code	Mar		Apr		May			June				July			Aug				Sept					Oct								
							3	4	1	2	3	4	1	2	3	4	1	2	3	4	5	1	2	3	4	1	2	3	4	1	2	3	4	5	1	2	3	4
<i>Paeonia</i> 'Exotic Era'	Lutea Hybrid Tree Peony	sm-west	w	w	n	la							x	p																								
<i>Paeonia</i> 'Extra Sweet Pink'	Peony	pw	p	01	24									x	p	p	p	p																				
<i>Paeonia</i> 'Fairy's Petticoat'	Double Peony	pw	p	03	16									e	x	p	p	p																				
<i>Paeonia</i> 'Fen Lan Pan'	Chinese Tree Peony	sm-east	w	e	s	la							e	x	p																							
<i>Paeonia</i> 'Feng Dan Bai'	Chinese Tree Peony	sm-west	w	w	n	la							x	x	p																							
<i>Paeonia</i> 'Festiva Maxima'	Double Peony	pw	p	03	02									x	p	p	p	p																				
<i>Paeonia</i> 'Firebell'	Semi-double Peony	pw	p	04	03									x	x	p	p	p																				
<i>Paeonia</i> 'First Arrival'	Intersectional Hybrid Peony	pg	p	07	n									e	x	x	p																					
<i>Paeonia</i> 'Flame'	Single Peony	pg	p	01	s									x	x	p																						
<i>Paeonia</i> 'Flame'	Single Peony	pw	p	02	32									x	p	p	p	p																				
<i>Paeonia</i> 'Frankie Curtis'	Double Peony	pw	p	04	30										e	x	p	p	p																			
<i>Paeonia</i> 'Friendship'	Single Peony	pw	p	03	03										x	p	p	p																				
<i>Paeonia</i> 'Fuji-No-Mine'	Japanese Peony	pg	p	09	e								e	e	e	e	x	p																				
<i>Paeonia</i> 'Gessekai'	Japanese Tree Peony	sm-west	w	w	s	la								x	p																							
<i>Paeonia</i> 'Glory Hallelujah'	Double Peony	pw	p	06	20											x	p	p	p																			
<i>Paeonia</i> 'Godaishu'	Japanese Tree Peony	sm-west	w	nw											x	p																						
<i>Paeonia</i> 'Golden Era'	Lutea Hybrid Tree Peony	sm-west	w	w	m	la									x	p																						
<i>Paeonia</i> 'Golden Glow'	Single Peony	pw	p	03	13										e	x	p	p	p																			
<i>Paeonia</i> 'Golden Hind'	Lutea Hybrid Tree Peony	sm-west	w	w	m	la										x	p																					
<i>Paeonia</i> 'Golden Vanitie'	Lutea Tree Peony	sm-west	w	w	n	la										x	p																					
<i>Paeonia</i> 'Green Lotus'	Single Peony	pw	p	02	04											e	p	p	p																			
<i>Paeonia</i> 'Guardian of the Monastery'	Lutea Tree Peony	sm-west	w	w	n	la										p																						
<i>Paeonia</i> 'Guidon'	Double Peony	pg	p	09	e									e	e	e	e	x	p																			
<i>Paeonia</i> 'Guidon'	Double Peony	pw	p	06	24												x	x	p	p																		
<i>Paeonia</i> 'Hana - Daigin'	Japanese Tree Peony	sm-east	w	e	s	la									e	x	p																					
<i>Paeonia</i> 'Hana-Daigin'	Japanese Tree Peony	sm-west	w	nw		la										e	x	p																				
<i>Paeonia</i> 'Hatsu-Garasu'	Japanese Tree Peony	sm-west	w	w	m	la										e	p																					
<i>Paeonia</i> 'Hatsu-Hinod'	Japanese Tree Peony	sm-east	w	e	n	la										e	x	p																				
<i>Paeonia</i> 'Hawaiian Sunset'	Japanese Peony	pw	p	02	12												x	x	p	p																		
<i>Paeonia</i> 'Helen'	Single Peony	pg	p	02	b										e	x	x	p																				
<i>Paeonia</i> 'Helen'	Single Peony	pw	p	02	28											x	x	p	p	p																		
<i>Paeonia</i> 'Heritage'	Semi-double Peony	pw	p	01	48											e	x	p	p	p																		
<i>Paeonia</i> 'Hermoire'	Double Peony	pw	p	01	36												e	p	p	p																		
<i>Paeonia</i> 'Hino-Tsukasa'	Japanese Tree Peony	sm-west	w	w	s	la										e	x	p																				
<i>Paeonia</i> 'Horaison'	Japanese Tree Peony	sm-east	w	e	m	la											x	p																				
<i>Paeonia</i> 'Hua Hu Die'	Chinese Tree Peony	sm-east	w	e	n	la											e	p																				
<i>Paeonia</i> 'Ice Storm'	Tree Peony	sm-east	w	e	m	la											x	p																				
<i>Paeonia</i> 'Imperial Red'	Single Peony	pw	p	04	38												x	x	p	p	p																	
<i>Paeonia</i> 'Janice'	Semi-double Peony	pw	p	01	08												e	p	p	p	p																	
<i>Paeonia japonica</i>	Japanese Peony	rg	p	e										x																								
<i>Paeonia</i> 'Jean E. Bockstoce'	Double Peony	pw	p	01	27												e	x	p	p	p																	
<i>Paeonia</i> 'Jeanne D'Arc'	European Tree Peony	sm-west	w	w	m	la											e	x	p																			
<i>Paeonia</i> 'Jeanne Ernould'	Single Peony	pw	p	04	17												x	p	p	p	p																	
<i>Paeonia</i> 'Joseph Christie'	Double Peony	pw	p	03	15													e	x	p	p																	
<i>Paeonia</i> 'Judge Snook'	Double Peony	pw	p	03	08												x	p	p	p	p																	
<i>Paeonia</i> 'Judy Becker'	Double Peony	pw	p	04	33												x	x	p	p	p																	
<i>Paeonia</i> 'Julia Rose'	Intersectional Hybrid Peony	pg	p	10	w	la											e	x																				
<i>Paeonia</i> 'June Rose'	Double Peony	pw	p	04	13												x	p	p	p	p																	
<i>Paeonia</i> 'Kamada-Nishiki'	Japanese Tree Peony	sm-east	w	e	s	la											e	p																				

2010 Perennials in Bloom (Alpha Order of Botanical Name)

Botanical Name	Common Name	Garden	Type	Bed	Loc	Code	Mar			Apr			May				June					July				Aug				Sept					Oct										
							3	4	1	2	3	4	1	2	3	4	1	2	3	4	5	1	2	3	4	1	2	3	4	1	2	3	4	5	1	2	3	4							
<i>Paeonia</i> 'Taisho-No-Hokori'	Japanese Tree Peony	sm-east	w	e	s	la								e	x	p																													
<i>Paeonia</i> 'Taiya'	Japanese Tree Peony	sm-east	w	e	m	la									x	p																													
<i>Paeonia</i> 'Taiyo'	Japanese Tree Peony	sm-west	w	w	m	la									e	p																													
<i>Paeonia</i> 'Tango'	Single Peony	pw	p	01	42										x	p	p	p	p	p																									
<i>Paeonia tenuifolia</i> 'Flore Pleno'	Fern-leaved Peony	pg	p	17	s						e	e		e	x	p																													
<i>Paeonia tenuifolia</i> 'Flore Pleno'	Fern-leaved Peony	pg	p	07	s								e	e	x																														
<i>Paeonia</i> 'Therese'	Double Peony	pw	p	04	25												e	x	x	p	p																								
<i>Paeonia</i> 'Thunderbolt'	Lutea Hybrid Tree Peony	sm-east	w	e	n	la									e	e	x	p																											
<i>Paeonia</i> 'Top Brass'	Double Peony	pw	p	04	14												x	p	p	p	p																								
<i>Paeonia</i> 'Tsukie-Moi-Tiski'	Japanese Hybrid Tree Peony	sm-west	w	w	s	la									e	p																													
<i>Paeonia</i> 'Twitterpated'	Semi-double Peony	pw	p	02	31												x	p	p	p	p																								
<i>Paeonia</i> 'Victoire de la Marne'	Double Peony	pw	p	04	22												x	p	p	p	p																								
<i>Paeonia</i> 'Vivid Rose'	Double Peony	pw	p	04	07												e	x	x	p																									
<i>Paeonia</i> 'Walter Mains'	Japanese Peony	pg	p	08	w										e	x	p																												
<i>Paeonia</i> 'Walter Mains'	Japanese Peony	pw	p	01	30												x	p	p	p	p																								
<i>Paeonia</i> 'Weisse'	European Tree Peony	sm-west	w	w	n	la									e	x	p																												
<i>Paeonia</i> 'White Cap'	Japanese Peony	pg	p	04	e												x	x	x																										
<i>Paeonia</i> 'White Gold'	Japanese Peony	pw	p	02	07												x	p	p	p																									
<i>Paeonia</i> 'Whopper'	Double Peony	pw	p	03	10												e	x	p	p																									
<i>Paeonia</i> 'Your Majesty'	Single Peony	pw	p	06	15												x	p	p	p	p																								
<i>Paeonia</i> 'Zi Die Ying Feng'	Chinese Rockii Tree Peony	sm-west	w	w	n	la									e	x	p																												
<i>Panicum</i> 'Amber Waves'	Switch Grass	pg	p	02	mb																																								
<i>Panicum virgatum</i> 'Cloud Nine'	Switch Grass	ec-n	p	01		la																																							
<i>Panicum virgatum</i> 'Dallas Blues'	Switch Grass	ec-s	p	sbs		la																																							
<i>Panicum virgatum</i> 'Dallas Blues'	Switch Grass	ec-s	p	sbn		nl																																							
<i>Panicum virgatum</i> 'Heavy Metal'	Switch Grass	ec-n	p	04		la																																							
<i>Panicum virgatum</i> 'Northwind'	Switch Grass	ec-n	p	01		la																																							
<i>Panicum virgatum</i> 'Northwind'	Switch Grass	ec-s	p	12		la																																							
<i>Panicum virgatum</i> 'Northwind'	Switch Grass	pg	p	13	eb																																								
<i>Panicum virgatum</i> 'Rotstrahlbusch'	Switch Grass	pg	p	17	sb																																								
<i>Papaver orientale</i> 'Bonfire'	Oriental Poppy	pg	p	02	e	nl									e	x	e	e	p																										
<i>Papaver orientale</i> 'Cheerio'	Oriental Poppy	pg	p	11	e	la											x	x	p																										
<i>Papaver orientale</i> 'Crimson Pom Pom'	Oriental Poppy	pg	p	04	w												x	p																											
<i>Papaver orientale</i> 'Orange Scarlet'	Oriental Poppy	pg	p	10	e	la											e	x																											
<i>Papaver orientale</i> 'Pizzicato'	Oriental Poppy	pg	p	10	e	la											e																												
<i>Papaver orientale</i> 'Royal Wedding'	Oriental Poppy	ec-n	p	fee		la											x	x	p	c																									
<i>Papaver orientale</i> 'Royal Wedding'	Oriental Poppy	pg	p	04	e												e	x	p																										
<i>Papaver orientale</i> 'Türkenlouis' (syn. 'Turkish Delight')	Oriental Poppy	pg	p	03	w												e	e	x	p																									
<i>Papaver orientale</i> 'Whirlwind'	Oriental Poppy	pg	p	09	m												e	x	x																										
<i>Papaver somniferum</i>	Opium Poppy	hg	p	02		la																																							
<i>Parthenium integrifolium</i>	Wild Quinine	hg	p	04	n	la																																							
<i>Parthenium integrifolium</i>	Wild Quinine	pg	p	10	e	la																																							
<i>Pennisetum alopecuroides</i> 'Hameln'	Fountain Grass	ec-n	p	04		la																																							

2010 Perennials in Bloom (Alpha Order of Botanical Name)

Botanical Name	Common Name	Garden	Type	Bed	Loc	Code	Mar		Apr			May			June					July				Aug					Sept					Oct						
							3	4	1	2	3	4	1	2	3	4	1	2	3	4	5	1	2	3	4	1	2	3	4	1	2	3	4	5	1	2	3	4		
<i>Primula x polyantha</i> 'Spring Pastels'	Polyantha Primrose	rg	p	i-e	s					x	x	x	x	x	x																									
<i>Prunus nigra</i> 'Princess Kay'	Flowering Plum	pg	w	06	s						x	x	p																											
<i>Prunus nigra</i> 'Princess Kay'	Flowering Plum	pg	w	12	n	la					e	x	p																											
<i>Prunus tomentosa</i>	Manchu or Nanking Cherry	pg	w	07	n						x																													
<i>Pulmonaria</i> 'Dark Vader'	Lungwort	pg	p	15	s						x	x	x	x	x	p																								
<i>Pulmonaria</i> 'Gaelic Spring'	Lungwort	pg	p	09	wb						x		x	x	x																									
<i>Pulmonaria</i> 'Majesté'	Lungwort	pg	p	08	w						x			x	x	x																								
<i>Pulmonaria officianalis</i> 'Sissinghurst White'	Common Lungwort Cv.	pg	p	09	w						x			e	x	x																								
<i>Pulmonaria</i> 'Raspberry Splash'	Lungwort	pg	p	13	w									e	x	x	p																							
<i>Pulmonaria</i> 'Roy's Boy'	Lungwort	rg	p	i-e	s							x	x	x	x	x	x																							
<i>Pulmonaria saccharata</i>	Bethlehem Sage	pg	p	11	e	la										x	x	x																						
<i>Pulmonaria saccharata</i> 'Bielefeld Pink'	Bethlehem Sage	pg	p	09	e																																			
<i>Pulmonaria saccharata</i> 'Excalibur'	Bethlehem Sage	pg	p	08	e																																			
<i>Pulmonaria saccharata</i> 'Margery Fish'	Bethlehem Sage	pg	p	07	s						x	x			e	x	x																							
<i>Pulmonaria saccharata</i> 'Milky Way'	Bethlehem Sage	pg	p	07	n											e	x	x																						
<i>Pulmonaria saccharata</i> 'Spilled Milk'	Bethlehem Sage	pg	p	09	e						x	x			e	x	x																							
<i>Pulmonaria</i> 'Salmon Glow'	Lungwort	rg	p	cw-e							x	x	x	x	x	x	x	x																						
<i>Pulmonaria</i> 'Samurai'	Lungwort	pg	p	13	w										e	x	x	x	x	x	p																			
<i>Pulmonaria</i> 'Trevi Fountain'	Lungwort	pg	p	11	e	la									e	e	x	x	x	x	x	p																		
<i>Pulsatilla vulgaris</i> 'Papageno'	Pasque Flower	pg	p	10	m	la									e	x	x	x	x	x	x	p																		
<i>Pulsatilla vulgaris</i> 'Papageno'	Pasque Flower	pg	p	13	e												x	x	x	x	p																			
<i>Pulsatilla vulgaris</i> 'Papageno'	Pasque Flower	pg	p	09	w																																			
<i>Pulsatilla vulgaris</i> 'Rote Glocke'	Pasque Flower	pg	p	03	b	nm									e	x	x	x	x	x	p																			
<i>Pulsatilla vulgaris</i> 'Rote Glocke'	Pasque Flower	pg	p	02	b	nn									e	x	x	p																						
<i>Puschkinia libanotica</i>	Striped Squill	ec-n	b	06		map										x	p																							
<i>Puschkinia scilloides</i>	Striped Squill	rg	p	e												x	x	p																						
<i>Pycnanthemum pilosum</i>	Mountain Mint	hg	p	12	w	la																																		
<i>Ranunculus acris</i> 'Flore Pleno'	Meadow Buttercup	pg	p	02	w																																			
<i>Ranunculus acris</i> 'Flore Pleno'	Meadow Buttercup	pg	p	05	w	nl																																		
<i>Ranunculus acris</i> var. <i>stevanii</i>	Meadow Buttercup	pg	p	10	e	la																																		
<i>Ranunculus bulbosus</i>	Bulbous Buttercup	hg	p	02	ni	la																																		
<i>Ranunculus montanus</i> 'Molten Gold'	Mountain Buttercup	pg	p	03	w																																			
<i>Rhododendron</i> 'Golden Lights'	Fragrant Azalea	ec-n	w	01		la																																		
<i>Rhododendron</i> sp.	Rhododendron	gh	w	nw																																				
<i>Rhododendron x marjatta</i> 'Mikkeli'	Marjatta Hybrid	ec-n	w	06		la																																		
<i>Rhodotypos scandens</i>	Black Jet Bead	ec-n	w	06		la																																		
<i>Rhus aromatica</i>	Fragrant Sumac	gh	w	w																																				
<i>Rhus aromatica</i>	Fragrant Sumac	hg	w	12	eo	la																																		
<i>Rhus aromatica</i> 'Grow Low'	Fragrant Sumac Cv.	sm-west	w	w	n	la																																		
<i>Rodgersia pinnata</i>	Featherleaf Rodgersia	pg	p	15	s																																			
<i>Rodgersia pinnata</i> var. <i>superba</i>	Featherleaf Rodgersia	pg	p	09	e																																			
<i>Rosa</i>		ec-n	w	few		nl																																		
<i>Rosa</i> 'Blushing Knockout'		ec-s	p	sbs		la																																		
<i>Rosa</i> 'Charles Albanel'	Hybrid Rugosa Rose	ec-s	w	12		la																																		
<i>Rosa</i> 'DayDream'	DayDream™ Shrub Rose	ec-n	w	01		la																																		
<i>Rosa eglantheria</i>	Sweet Briar	hg	w	12	eo	la																																		
<i>Rosa eglantheria</i>	Sweet Briar	hg	w	11	w	la																																		

2010 Perennials in Bloom (Alpha Order of Botanical Name)

Botanical Name	Common Name	Garden	Type	Bed	Loc	Code	Mar		Apr				May				June					July				Aug					Sept					Oct																			
							3	4	1	2	3	4	1	2	3	4	1	2	3	4	1	2	3	4	1	2	3	4	1	2	3	4	5	1	2	3	4																		
<i>Rosa</i> 'Flower Carpet'	Shrub Rose	ec-n	w	04		la												e	x	x	x	x	x	x	x	x	x	x	x	x	x	p	p	p																					
<i>Rosa gallica</i> var. <i>officinalis</i>	Apothecary Rose	hg	p	08	w	la						x	x	x	x	x	p																																						
<i>Rosa</i> 'Home Run'	Shrub Rose	ec-s	w	05		la												x	x	x	x	x																			x	x	x	x											
<i>Rosa</i> 'Knockout'	Shrub Rose	ec-s	w	03		map									e	x	x	x	x																							x	x	x	x										
<i>Rosa</i> 'Meikentuk'	Colleen Mary™ Hybrid Tea Rose	ec-n	w	01		la												e	x	x	x	x	x	x	x	x	x	x	x	x	x	x	p	p	p																				
<i>Rosa</i> 'Pink Knockout'		ec-s	p	sbs		la												e	x	x	x	x																																	
<i>Rosa</i> 'Radbrite'	Brite Eyes™ Climber Rose	ec-n	w	01		la												x	x	x	x	x	x	p																					x	x	p								
<i>Rosa</i> 'Radmor'	Morning Magic™ Climber Rose	ec-n	w	01		la								x	x	x	x	x	x	x	p																										x	p							
<i>Rosa</i> 'Radwin'	Winner's Circle™ Climber Rose	ec-n	w	01		la												x	x	x	x	x	x	p																								p							
<i>Rosa</i> 'Starry Night'	Shrub Rose	ec-s	w	12		la												e	x	x	x	x																																	
<i>Rosa</i> 'Sweet Promise' "5 plants with salmon flowers on right side)	Sweet Promise™ Hybrid Tea Rose	ec-n	p	few		nl																																																	
<i>Rosa</i> x 'Therese Bugnet'	Hybrid Rugosa Rose	ec-s	w	12		la										e	x	x	x	x	p																											r	r	r	p				
<i>Rubia tinctorum</i>	Madder	hg	p	11	m	la													x																																				
<i>Rubus odoratus</i>	Flowering Raspberry	hg	w	11	w	la																																																	
<i>Rudbeckia fugida</i> 'Goldsturm'	Coneflower	ec-s	p	05		map																																																	
<i>Rudbeckia fulgida</i> 'Goldsturm'	Coneflower	ec-n	p	04		la																																																	
<i>Rudbeckia fulgida</i> 'Goldsturm'	Coneflower	pg	p	10	w	la																																																	
<i>Rudbeckia fulgida</i> 'Goldsturm'	Coneflower	pg	p	03	bb																																																		
<i>Rudbeckia fulgida</i> 'Goldsturm'	Coneflower	pg	p	05	e																																																		
<i>Rudbeckia laciniata</i> 'Golden Glow'	Cutleaf Coneflower	pg	p	02	wb																																																		
<i>Rudbeckia nitida</i> 'Herbstonne' ('Autumn Sun')	Coneflower	ec-s	p	05		la																																																	
<i>Rudbeckia purpurea</i> CORRECT NAME IS <i>Echinacea purpurea</i> 'Double Decker'	Purple Coneflower	ec-s	p	05		wr																																																	
<i>Rudbeckia speciosa</i> 'Goldsturm'	Showy Coneflower	hg	p	11	e	la																																																	
<i>Rudbeckia triloba</i>	Three-lobed Coneflower	pg	p	02	mwb																																																		
<i>Ruellia humilis</i>	Fringeleaf Wild Petunia	ec-s	p	sbs		la																																																	
<i>Ruellia humilis</i>	Wild Petunia	pg	p	04	e																																																		
<i>Ruellia humilis</i>	Wild Petunia	pg	p	05	w	nl																																																	
<i>Ruellia humilis</i>	Wild Petunia	rg	p	i-w	e																																																		
<i>Ruellia humilis</i>	Wild Petunia	pg	p	11	w	la																																																	
<i>Rumex sanguineus</i> ssp. <i>Sanguineus</i>	Bloody Dock	pg	p	13	m																																																		
<i>Rumex scutatus</i>	French Sorrel	hg	p	03		la																																																	
<i>Rumex scutatus</i>	French Sorrel	hg	p	11	e	la																																																	
<i>Ruta graveolens</i>	Rue	hg	p	11	e	la																																																	
<i>Salvia nemorosa</i> 'Dear Anja'	Hybrid Sage	pg	p	02	w																																																		
<i>Salvia nemorosa</i> 'Amethyst'	Hybrid Sage	pg	p	06	s																																																		
<i>Salvia nemorosa</i> 'Blauhügel' (syn. 'Blue Hill')	Hybrid Sage	pg	p	01	mf																																																		
<i>Salvia nemorosa</i> 'Blue Queen'	Hybrid Sage	ec-s	p	sbs		nl																																																	
<i>Salvia nemorosa</i> 'Caradonna'	Hybrid Sage	pg	p	04	w																																																		
<i>Salvia nemorosa</i> 'Dwarf Blue Queen'	Hybrid Sage	ec-n	p	04		la																																																	
<i>Salvia nemorosa</i> 'East Friesland' (syn. 'Ostfriesland')	Hybrid Sage	ec-n	p	04		la																																																	
<i>Salvia nemorosa</i> 'Marcus'	Hybrid Sage	ec-s	p	sbn		la																																																	
<i>Salvia nemorosa</i> 'Tanzerin'	Hybrid Sage	pg	p	17	s																																																		
<i>Salvia nemorosa</i> 'Wesuwe'	Hybrid Sage	pg	p	04	w																																																		

2010 Perennials in Bloom (Alpha Order of Botanical Name)

Botanical Name	Common Name	Garden	Type	Bed	Loc	Code	Mar				Apr				May				June				July				Aug				Sept				Oct														
							3	4	1	2	3	4	1	2	3	4	1	2	3	4	1	2	3	4	1	2	3	4	1	2	3	4	1	2	3	4	1	2	3	4									
<i>Sedum kamtschaticum</i>	Kamschatka Stonecrop	pg	p	12	nf	la									x	x																																	
<i>Sedum kamtschaticum</i>	Kamschatka Stonecrop	rg	p	cw-e											x	x	x	x	x	x	x	x	x	x																									
<i>Sedum kamtschaticum</i>	Kamschatka Stonecrop	rg	p	i-e	n										x	x	x	x	x	x																													
<i>Sedum kamtschaticum</i> v. <i>floriferum</i>	Stonecrop	ec-n	p	06		la									x	x	x	x																															
<i>Sedum kamtschaticum</i> var. <i>floriferum</i> 'Weihenstephaner Gold'	Kamschatka Stonecrop	pg	p	11	w	nl									e	x	x	x			e																												
<i>Sedum kamtschaticum</i> var. <i>floriferum</i> 'Weihenstephaner Gold'	Kamschatka Stonecrop	pg	p	12	sf	nl									x	x	x	p																															
<i>Sedum makinoi</i> 'Matrona'	Stonecrop	pg	p	01	s															e	e	x	p																										
<i>Sedum</i> 'Purple Emperor'	Stonecrop	pg	p	02	e																																												
<i>Sedum reflexum</i>	Stonecrop	hg	p	02	e	la																																											
<i>Sedum</i> 'Rosy Glow'	Stonecrop	pg	p	14	wf																																												
<i>Sedum rupestre</i> 'Angelina'	Stonecrop	sm-east	p	e	m	la																																											
<i>Sedum rupestre</i> 'Angelina'	Stonecrop	sm-west	p	w	n	la																																											
<i>Sedum rupestre</i> 'Angelina'	Stonecrop	ec-n	p	04		la																																											
<i>Sedum rupestre</i> 'Angelina'	Stonecrop	ec-s	p	02		la																																											
<i>Sedum selskianum</i> 'Goldilocks'	Stonecrop	pg	p	03	wf	nl																																											
<i>Sedum selskianum</i> 'Goldilocks'	Stonecrop	pg	p	02	w	nn																																											
<i>Sedum selskianum</i> 'Goldilocks'	Stonecrop	pg	p	04	w										x																																		
<i>Sedum selskianum</i> 'Spirit'	Stonecrop	pg	p	10	e	la																																											
<i>Sedum sieboldii</i>	Siebold Stonecrop	pg	p	02	w	nl																																											
<i>Sedum sieboldii</i>	Siebold Stonecrop	pg	p	15	s																																												
<i>Sedum spectabile</i> 'Atropurpureum'	Showy Stonecrop	pg	p	02	m																																												
<i>Sedum spectabile</i> 'Carl'	Stonecrop	pg	p	06	s																																												
<i>Sedum spectabile</i> 'Carmen'	Showy Stonecrop	ec-s	p	05		la																																											
<i>Sedum spectabile</i> 'Lajos'	Autumn Charm™ Stonecrop	pg	p	04	w																																												
<i>Sedum spectabile</i> 'Variegatum'	Showy Stonecrop	pg	p	02	e																																												
<i>Sedum spurium</i> 'John Creech'	Stonecrop	ec-s	p	02		la																																											
<i>Sedum spurium</i> 'Red Carpet'	Two-row Stonecrop	ec-n	p	04		la																																											
<i>Sedum telephium</i> 'Emperor's Wave'	Stonecrop	pg	p	04	e																																												
<i>Sedum telephium</i> 'Gooseberry Fool'	Stonecrop	pg	p	02	e																																												
<i>Sedum telephium</i> 'Indian Chief'	Stonecrop	pg	p	11	m	la																																											
<i>Sedum telephium</i> var. <i>maximum</i> 'Honey Song'	Stonecrop	pg	p	02	e																																												
<i>Sedum ternatum</i>	Mountain Stonecrop	rg	p	w-st											x	x																																	
<i>Sedum</i> 'Voodoo'	Stonecrop	pg	p	03	e	nl																																											
<i>Sedum</i> 'Voodoo'	Stonecrop	pg	p	01	s																																												
<i>Sedum</i> 'Voodoo'	Stonecrop	pg	p	11	b	la																																											
<i>Sedum</i> 'Voodoo'	Stonecrop	pg	p	10	b	nl																																											
<i>Sedum</i> x 'Autumn Joy' (syn. 'Herbstfreude')	Stonecrop	ec-s	p	12		la																																											
<i>Sedum</i> x 'Autumn Joy' (syn. 'Herbstfreude')	Stonecrop	pg	p	04	m																																												
<i>Sedum</i> x 'Bertram Anderson'	Stonecrop	pg	p	03	m																																												
<i>Sedum</i> x 'Frosty Morn'	Stonecrop	pg	p	02	ef																																												
<i>Sedum</i> x <i>spectabile</i> 'Neon'	Stonecrop	pg	p	04	w																																												
<i>Sedum</i> x 'Vera Jameson'	Stonecrop	pg	p	10	e	la																																											
<i>Sesleria heufferiana</i>	Moor Grass	pg	p	13	e																																												
<i>Sidalcea malviflora</i> 'Party Girl'	Checkerbloom	pg	p	05	w																																												
<i>Silene regina</i> 'Prairie Fire'	Royal Catchfly	rg	p																																														
<i>Silphium integrifolium</i>	Rosin Weed	pg	p	06	s																																												
<i>Silphium perfoliatum</i>	Cup Plant	pg	p	01	nb																																												

2010 Perennials in Bloom (Alpha Order of Botanical Name)

Botanical Name	Common Name	Garden	Type	Bed	Loc	Code	Mar				Apr				May				June				July				Aug				Sept				Oct			
							3	4	1	2	3	4	1	2	3	4	1	2	3	4	1	2	3	4	1	2	3	4	1	2	3	4	1	2	3	4	1	2
<i>Silybum marianum</i>	Holy Thistle	hg	p	05	e	la																											e	e	x	x	p	
<i>Smilacina racemosa</i>	False Solomon's Seal	pg	p	12	n	la										x	x	p																				
<i>Smilacina stellata</i>	Star-flowered Solomon's Seal	rg	p	i-e	m										e	x	x	x																				
<i>Solidago caesia</i>	Wreath Goldenrod	rg	p	e-st																												x	x	x	x			
<i>Solidago canadensis</i>	Canada goldenrod	hg	p																																			
<i>Solidago canadensis</i>	Canada Goldenrod	hg	p	02	s	la																																
<i>Solidago canadensis</i> 'Peter Pan' (syn. 'Goldstrahl')	Goldenrod	pg	p	02	m																																	
<i>Solidago flexicaulis</i>	Zigzag Goldenrod	ec-s	p	05		la																																
<i>Solidago flexicaulis</i>	Zig-zag Goldenrod	rg	p	i-e	n																																	
<i>Solidago flexicaulis</i> 'Zig Zag'	Golden Rod	hg	p	12	e	la																																
<i>Solidago</i> 'Gold Spangles'	Goldenrod	pg	p	04	w																																	
<i>Solidago</i> 'Little Lemon'	Goldenrod	pg	p	04	e																																	
<i>Solidago rugosa</i> 'Fireworks'	Rough Stemmed Goldenrod	pg	p	05	w	nl																																
<i>Solidago rugosa</i> 'Fireworks'	Rough Stemmed Goldenrod	pg	p	01	n																																	
<i>Solidago rugosa</i> 'Fireworks'	Rough Stemmed Goldenrod	pg	p	12	n	la																																
<i>Solidago rugosa</i> 'Fireworks'	Rough Stemmed Goldenrod	ec-n	p	04		la																																
<i>Solidago sphacelata</i> 'Golden Fleece'	Goldenrod	pg	p	05	w																																	
<i>Sorbaria sorbifolia</i>	Ural False Spirea	rg	p	w-st	m																																	
<i>Sorghastrum nutans</i> 'Indian Steel'	Indian Grass	ec-s	p	12		la																																
<i>Spigelia marilandica</i> 'Little Redhead'		rg	p	cw-e	mw																																	
<i>Spiraea alba</i>	White Meadowsweet	hg	p	12	e	la																																
<i>Spiraea betulifolia</i> 'Tor'	Spirea	ec-n	w	06		la																																
<i>Spiraea decumbens</i>	White Lace Spirea	ec-s	w	12		map																																
<i>Spiraea fritschiana</i>	Korean Spirea	ec-n	w	04		la																																
<i>Spiraea japonica</i> var. 'Alpina-Daphne Spirea'	Daphne Spirea	ec-s	w	12		la																																
<i>Spiraea</i> sp.		rg	w																																			
<i>Spiraea x arguta</i>	Garland Spirea	pg	w	02	e																																	
<i>Spiraea x arguta</i>	Garland Spirea	hg	w	08	m	la																																
<i>Spiraea x cinerea</i> 'Grefsheim'	Grefsheim Spiraea	ec-s	w	12		la																																
<i>Spirea decumbens</i>	White Alpine Spirea	sm-west	w	w	s	la																																
<i>Spirea japonica</i> 'Shirobana'	Shirobana Japanese Spiraea	sm-east	w	e	s	la																																
<i>Sporobolus heterolepis</i>	Prairie Dropseed	ec-n	p	01		la																																
<i>Sporobolus heterolepis</i>	Prairie Dropseed	ec-s	p	12		la																																
<i>Stachys byzantina</i>	Lamb's Ear	pg	p	02	w																																	
<i>Stachys byzantina</i>	Lamb's Ear	hg	p	02	e	la																																
<i>Stachys byzantina</i> 'Helen Von Stein'	Lamb's Ear	ec-s	p	sbn		nl																																
<i>Stachys byzantina</i> 'Helen Von Stein'	Lamb's Ear	ec-s	p	sbs		la																																
<i>Stachys byzantina</i> 'Silky Fleece'	Lamb's Ears	pg	p	17	s																																	
<i>Stachys byzantina</i> 'Silver Carpet'	Lamb's Ear	ec-s	p	sbn		ge																																
<i>Stachys byzantina</i> 'Silver Carpet'	Lamb's Ear	ec-s	p	sbs		ge																																
<i>Stachys macrantha</i> (syn. <i>S. grandiflora</i>)	Big Betony	pg	p	03	ef																																	
<i>Stachys monnieri</i> 'Hummelo'	Betony	pg	p	04	e																																	
<i>Stachys officinalis</i> 'Rosea'	Wood Betony	pg	p	02	e																																	
<i>Stachys officinalis</i>	Betony	hg	p	11	e	la																																
<i>Stephanandra incisa</i> 'Crispa'	Cutleaf Stephanandra	rg	w	cw-e	me																																	
<i>Stephanandra incisa</i> 'Crispa'	Cutleaf Stephanandra	sm-west	w	w	s	la																																
<i>Stylophorum diphyllum</i>	Celandine Poppy	pg	p	11	eb	la																																

